

PU

Energy storage system (ESS) Fuses



AEP 32/65Vdc ESS Fuse



DESCRIPTION

Adler AEP series ESS fuses are engineered and manufactured for use in Industrial ESS and Power Distribution Protection, made from the highest quality materials and tested to the highest standards. With rated currents from 20A to 200A with a breaking capacity of 1.5kA.

FEATURES

- 65 Vdc / 32 Vdc ESS fuse
- Rated Current: 20-200 A
- Operating Temperature: -40 to 125 degrees °C
- Breaking Capacity: 1.0 kA at 65 Vdc (20-125A)
1.5 kA at 32 Vdc (20-200A)
- Installation Method: M5/M6 bolt installation
- Torque: M5:2.5±0.5N·m ; M6: 2.5±0.5N·m
- Recommended fuse holder: BHR030-15-M5

AGENCY INFORMATION

- Ref. to ISO 8820; UL 248
- Approval: TÜV, UL
- Manufactured under IATF 16949 quality system
- RoHS and REACH Compliant

APPLICATIONS

- ESS and BESS circuit protection
- Inverter Protection
- Power storage protection

PART NUMBER SYSTEM

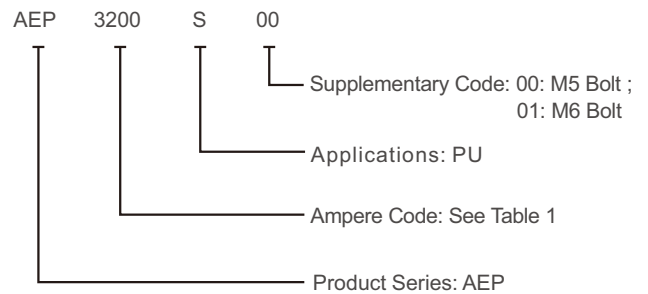

ELECTRICAL SPECIFICATIONS

Part Number	Rated Current	Ampere Code	Rated Voltage	Breaking Capacity	Certifications	
					TÜV	UL
AEP2200S00	AEP2200S01	20 A	32/65 Vdc	1 kA@65 Vdc 1.5 kA@32 Vdc	•	•
AEP2300S00	AEP2300S01	30 A			•	•
AEP2400S00	AEP2400S01	40 A			•	•
AEP2500S00	AEP2500S01	50 A			•	•
AEP2600S00	AEP2600S01	60 A			•	•
AEP2700S00	AEP2700S01	70 A			•	•
AEP2800S00	AEP2800S01	80 A			•	•
AEP3100S00	AEP3100S01	100 A			•	•
AEP3125S00	AEP3125S01	125 A			•	•
-	AEP3150S01	150 A			32 Vdc	1.5 kA@32 Vdc
-	AEP3175S01	175 A	•	•		
-	AEP3200S01	200 A	•	•		

Table1 Note: 1.●=Certification obtained. UL File number:E585737
2.Temperature rise: <50 K.

DIMENSIONS (mm)

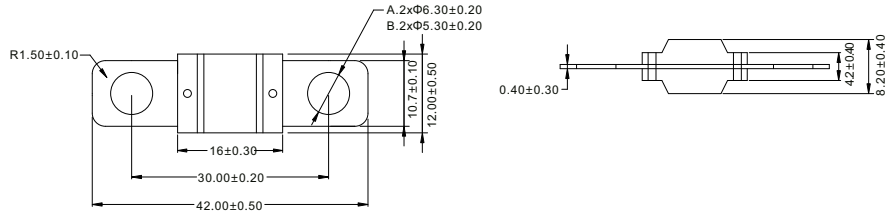

TIME VS CURRENT CHARACTERISTIC

Rated Current	75 %	100 %	110 %	150 %	200 %	300 %	350 %	500 %	600 %
20-125 A	-	>100 h	>4 h	90-3600 s	3-100 s	0.3-3 s	-	0.1-1 s	-
150 A-200 A	>100 h	-	-	-	1-15 s	-	0.3-5 s	-	0.1-1 s

TIME CURRENT CURVE

20A~125A

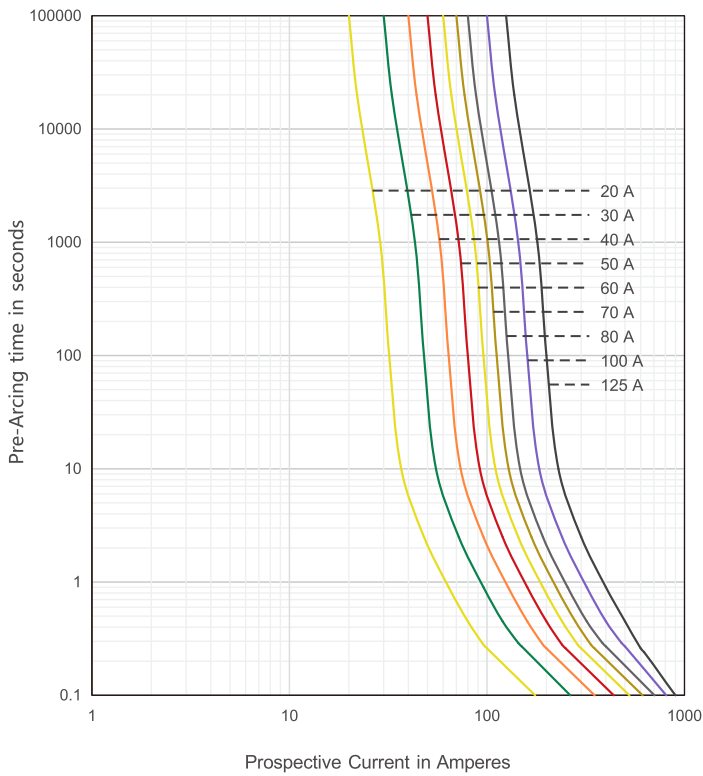

TIME CURRENT CURVE

150A~200A

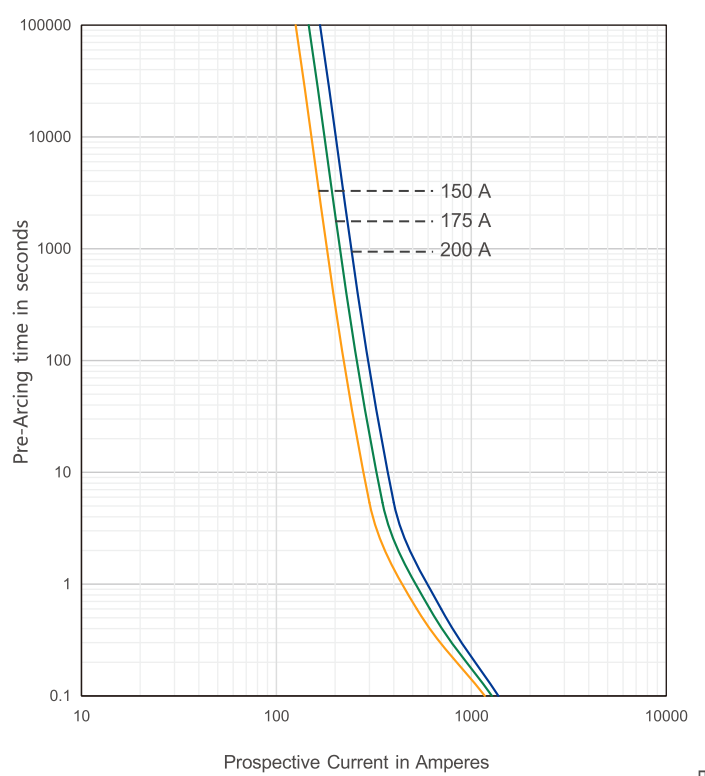

EFT 63/85/125/150/200 Vdc ESS Fuse

RoHS



DESCRIPTION

Adler EFT series ESS fuses are engineered and manufactured for use in Industrial ESS and Power Distribution Protection, made from the highest quality materials and tested to the highest standards. With rated currents from 100A to 500A with a breaking capacity of 20kA.

FEATURES

- Main Body: Ceramic
- Reliable clearing of DC fault currents
- Low watt losses
- Ultra-compact size and power density
- High breaking capacity to 20kA
- For Short Circuit Protection

AGENCY INFORMATION

- Designed to UL 248-13, ISO 20934-2019
- Manufactured under IATF 16949 quality system
- RoHS and REACH Compliant

APPLICATIONS

- ESS and BESS circuit protection
- Inverter Protection
- Power storage protection

PART NUMBER SYSTEM

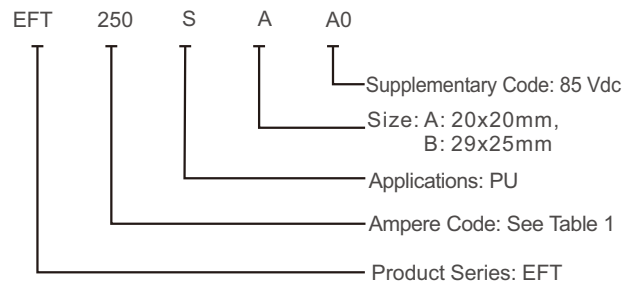

ELECTRICAL SPECIFICATIONS

Size (mm)	Part Number	Rated Current	Ampere Code	Rated Voltage	Breaking Capacity	Pre-Arcing I ² t (A ² s)
20x20	EFT100SAA0	100 A	100	150Vdc	3In-20kA	7200
	EFT150SAA0	150 A	150			16000
	EFT200SAA0	200 A	200			28500
	EFT250SAA0	250A	250			65400
	EFT300SAA0	300A	300			89300
	EFT350SAA0	350A	350			122500
20x20	EFT400SAA0	400 A	400	125Vdc	3In-20kA	192000
	EFT500SAA0	500 A	500			276000
20x20	EFT350SA02	350 A	350	85Vdc	3In-20kA	122500
	EFT400SA02	400 A	400			192000
	EFT500SA02	500 A	500			276000
20x20	EFT350SA05	350A	350	63Vdc	3In-20kA	122000
	EFT400SA05	400A	400			191000
	EFT500SA05	500A	500			275500
29x25	EFT350SB01	350A	350	200Vdc	3In-20kA	-
	EFT350SB01	400A	400			-

Table1 Note: (1). Pre-arcing I²t values are typical and tested at 10*In current.
 (2). * Self-certified for Breaking Capacity 20kA (T<2ms).

DIMENSIONS (mm)

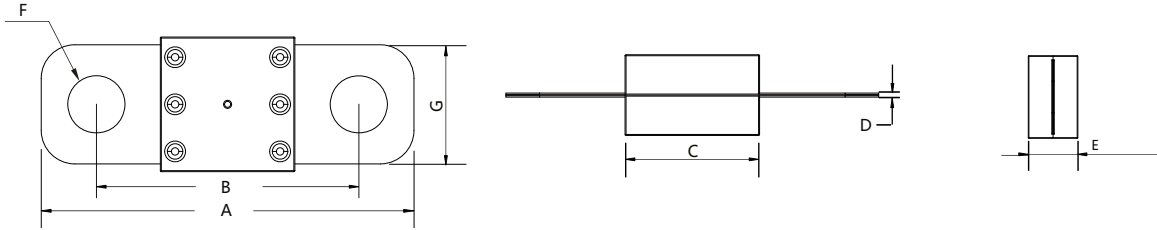

Size	A	B	C	D	E	F	G
20x20	55.4+1/-0.5	39±0.3	20+0.5/-0.1	0.6+0.1/-0.05	12+0.5/-0.2	φ8.5±0.3	17±0.5
29x25	78±1	56±0.5	29+0.6/-0.2	0.9±0.1	16+0.6/-0.2	φ8.2±0.2	22.7±0.5

Table2

TIME VS CURRENT CHARACTERISTIC

Part Number	Rated Current	100 %	300 %
EFTxxxxAxx	100-500 A	>4h	<10s

TIME CURRENT CURVE

EFTxxxxAxx 100A-500A

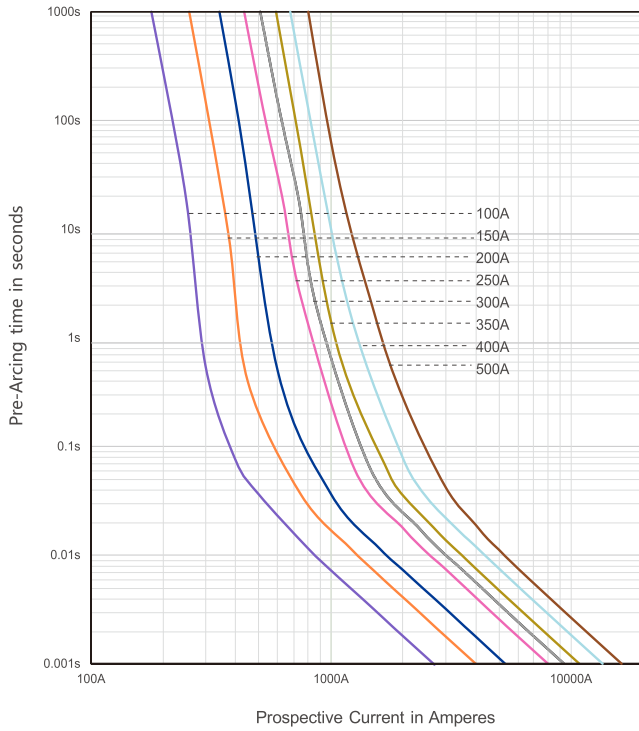

EFTxxxxBxx 350A-400A

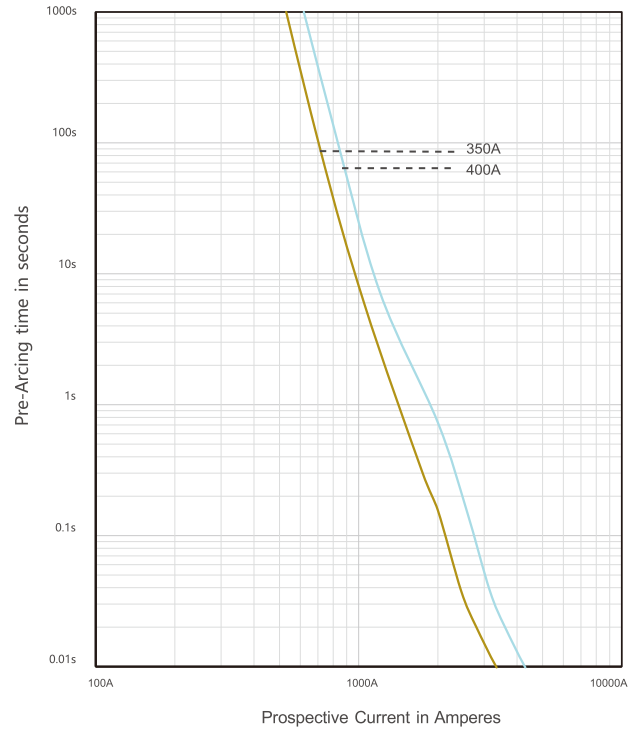

AEY 70 Vdc ESS Fuse



DESCRIPTION

Adler AEY series ESS fuses are engineered and manufactured for use in Industrial ESS and Power Distribution Protection, made from the highest quality materials and tested to the highest standards. With rated currents from 10A to 500A with a breaking capacity of 2.5kA.

FEATURES

- 70 Vdc ESS fuse
- Rated Current: 40-500 A
- Operating Temperature: -40 to 125°C
- Rated Breaking Capacity: 2.5 kA at 70 Vdc
- Bolt Size: M8
- Torque: M8:12N·m
- Recommended fuse holder: BHR059-25-M8, BHR051-25-M8, BHR050-25-M8

APPLICATIONS

- ESS and BESS circuit protection
- Inverter Protection
- Power storage protection

AGENCY INFORMATION

- Ref. to: UL248, ISO20934, ISO8820
- Approvals: UL (E485737) and TÜV (50551893)
- Manufactured under IATF 16949 quality system
- RoHS and REACH Compliant

PART NUMBER SYSTEM

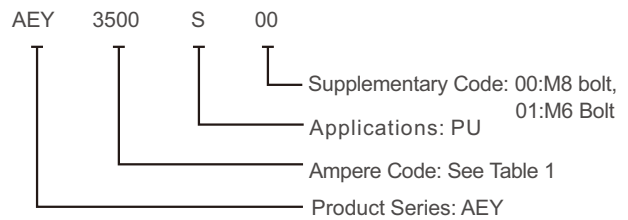

ELECTRICAL SPECIFICATIONS

Part Number		Rated Current	Ampere Code	Rated Voltage	Breaking Capacity	Voltage Drop Max.(mV)	I ² t(A ² S)		Certifications			
M8 Bolt	M6 Bolt						Pre-Areing	Total	UL	TUV		
AEY2100S00	-	10 A	2100	70 Vdc	2.5 kA@70 Vdc	135	120	178	•	•		
AEY2150S00	-	15 A	2150				380	450	•	•		
AEY2200S00	-	20 A	2200				620	700	•	•		
AEY2250S00	-	25 A	2250				860	1093	•	•		
AEY2300S00	-	30 A	2300				4300	1800	•	•		
AEY2350S00	-	35 A	2350				5900	3062	•	•		
AEY2400S00	AEY2400S01	40 A	2400				7600	8000	•	•		
AEY2500S00	AEY2500S01	50 A	2500				11875	12500	•	•		
AEY2600S00	AEY2600S01	60 A	2600				17100	18000	•	•		
AEY2700S00	AEY2700S01	70 A	2700				23275	24500	•	•		
AEY2800S00	AEY2800S01	80 A	2800				30400	32000	•	•		
AEY3100S00	AEY3100S01	100 A	3100				47500	50000	•	•		
AEY3125S00	AEY3125S01	125 A	3125				74219	78125	•	•		
AEY3150S00	AEY3150S01	150 A	3150			106875	11250	•	•			
AEY3175S00	AEY3175S01	175 A	3170			145769	15312	•	•			
AEY3200S00	AEY3200S01	200 A	3200			190000	20000	•	•			
AEY3225S00	AEY3225S01	225 A	3225			240469	25312	•	•			
AEY3250S00	AEY3250S01	250 A	3250			296875	31250	•	•			
AEY3300S00	AEY3300S01	300 A	3300			427500	45000	•	•			
AEY3350S00	AEY3350S01	350 A	3350			781250	80000	•	•			
AEY3400S00	AEY3400S01	400 A	3400			1120000	12000	•	•			
AEY3450S00	AEY3450S01	450 A	3450			1417500	15187	•	•			
AEY3500S00	AEY3500S01	500 A	3500			1750000	18750	•	•			
								80				

Table1 Note:1. •=Certification obtained. UL File number:E485737

DIMENSIONS (mm)

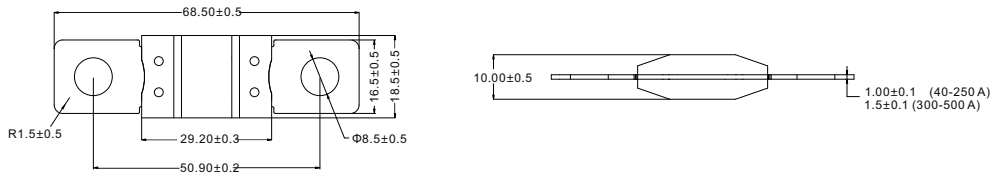

TIME VS CURRENT CHARACTERISTIC

Rated Current	75 %	100 %	135 %	200 %	350 %	600 %
40-250 A	-	>4 h	2-30 min	1-15 s	0.3-5 s	0.1-1 s
300-500 A	>4 h	-	-	1-15 s	0.3-5 s	0.1-1 s

Table2

TIME CURRENT CURVE

10A~250A

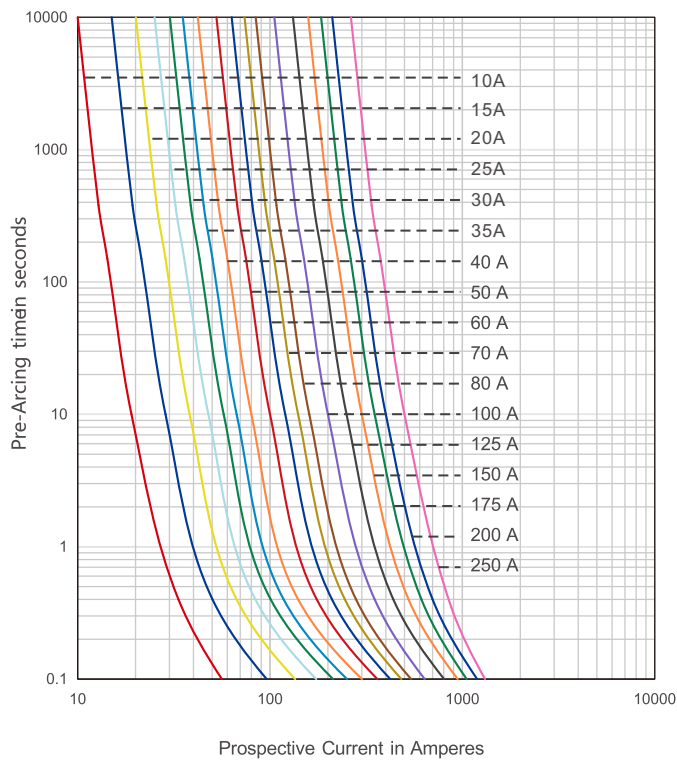

300A~500A

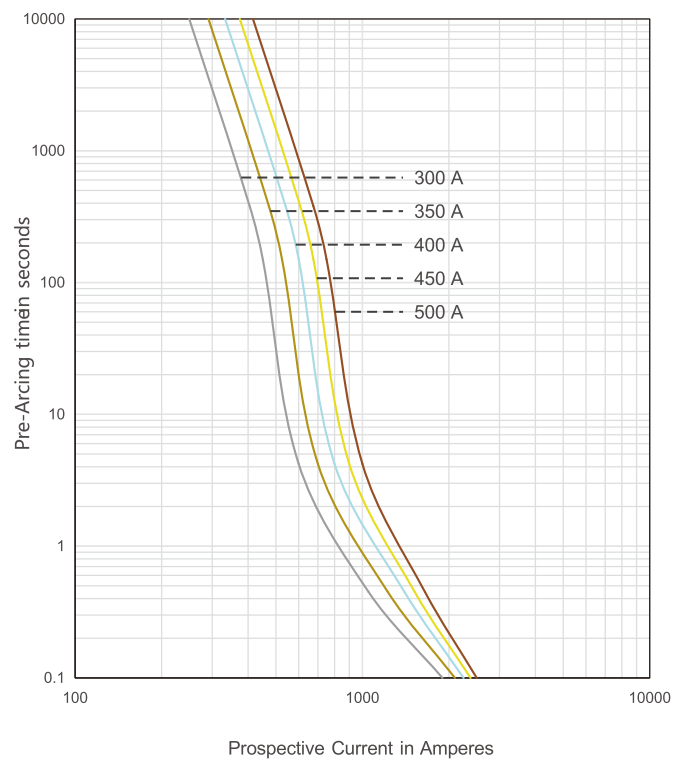

AEL 80 Vdc ESS Fuse

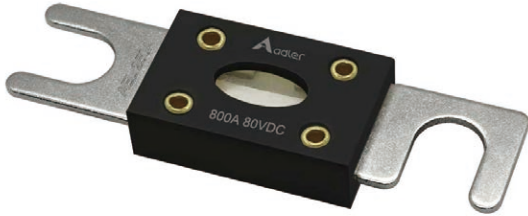

DESCRIPTION

Adler AEL series ESS fuses are engineered and manufactured for use in Industrial ESS and Power Distribution Protection, made from the highest quality materials and tested to the highest standards. With rated currents from 30A to 800A with a breaking capacity of 3kA.

FEATURES

- 80 Vdc ESS fuse
- Rated Current: 30-800 A
- Rated Breaking Capacity: 3 kA at 80 Vdc
- Bolt Size: M10
- Torque: M10:19 N·m
- Recommended fuse holder:
 BHR061-25-M10(with cover):30-200A;
 BHR061-25-M10-S(No cover):30-800A;

AGENCY INFORMATION

- Designed to UL 248; DIN 43560
- Manufactured under IATF 16949 quality system
- RoHS and REACH Compliant

APPLICATIONS

- ESS and BESS circuit protection
- Inverter Protection
- Power storage protection

PART NUMBER SYSTEM

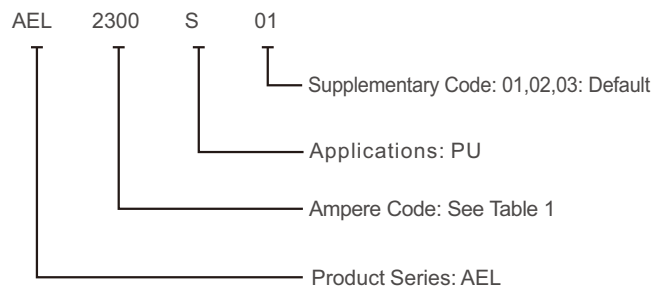

DIMENSIONS (mm)

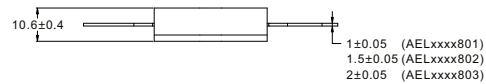
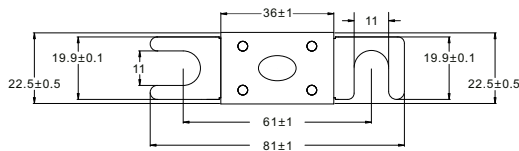



ELECTRICAL SPECIFICATIONS

Part Number	Rated Current	Ampere Code	Rated Voltage	Breaking Capacity	Certifications	
					UL	TUV
AEL2300S01	30 A	2300	80 Vdc	3kA@80 Vdc	●	●
AEL2400S01	40 A	2400			●	●
AEL2500S01	50 A	2500			●	●
AEL2600S01	60 A	2600			●	●
AEL2700S01	70A	2700			●	●
AEL2800S01	80 A	2800			●	●
AEL3100S01	100 A	3100			●	●
AEL3125S01	125 A	3125			●	●
AEL3130S01	130 A	3130			●	●
AEL3150S01	150 A	3150			●	●
AEL3175S01	175 A	3175			●	●
AEL3200S01	200 A	3200			●	●
AEL3225S01	225 A	3225			●	●
AEL3250S01	250 A	3250			●	●
AEL3275S01	275 A	3275			●	●
AEL3300S01	300 A	3300			●	●
AEL3325S01	325 A	3325	●	●		
AEL3350S02	350 A	3350	80 Vdc	3kA@80 Vdc	●	●
AEL3400S02	400 A	3400			●	●
AEL3500S02	500 A	3500			●	●
AEL3600S02	600 A	3600			●	●
AEL3675S03	675 A	3675	80 Vdc	3kA@80 Vdc	●	●
AEL3700S03	700A	3700			●	●
AEL3750S03	750 A	3750			●	○
AEL3800S03	800 A	3800			●	○

Table1 Note: 1. ●=Certification obtained, ○ = certification in process.
 2. Temperature rise: <50 K.

TIME CURRENT CURVE

AELxxxx801

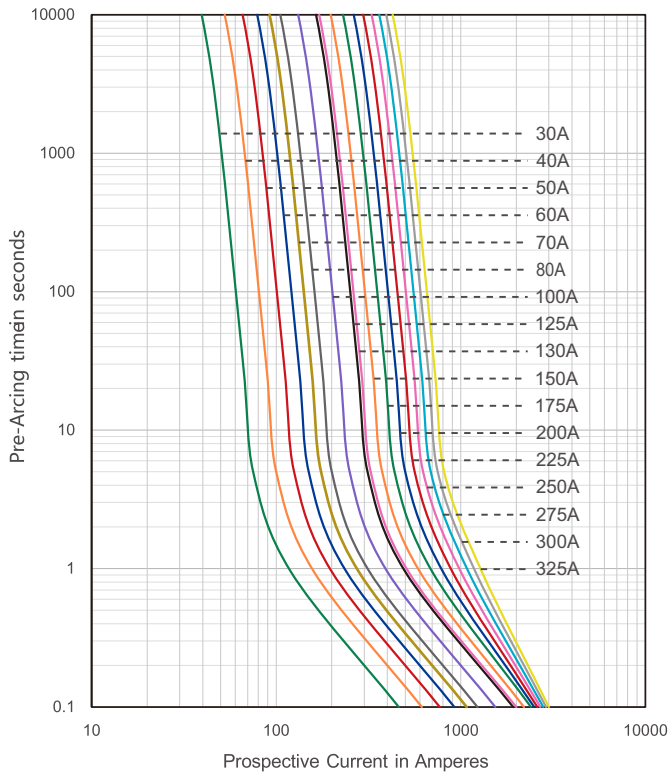

AELxxxx802/AELxxxx803

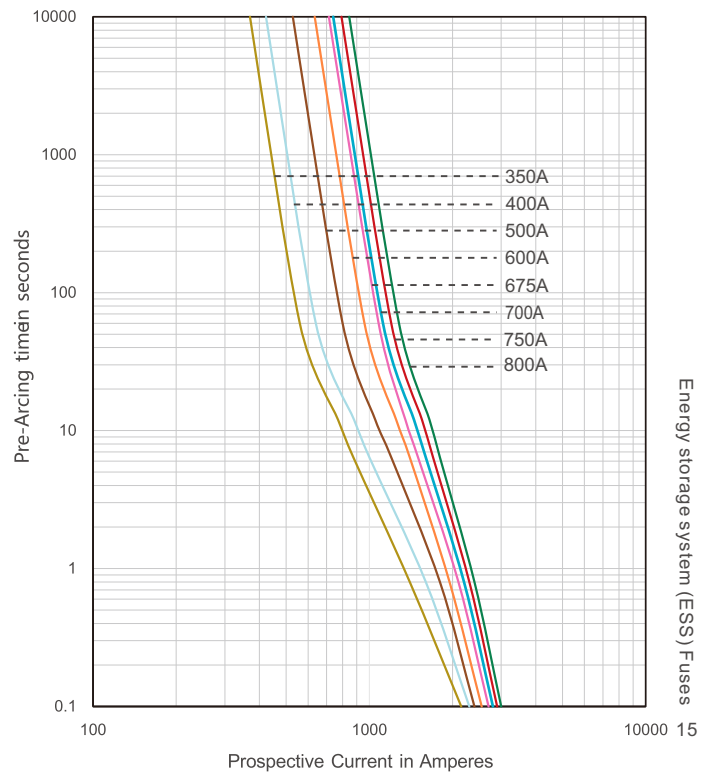

EFP 125 Vdc ESS Fuse



DESCRIPTION

Adler EFP series ESS fuses are engineered and manufactured for use in Industrial ESS and Power Distribution Protection, made from the highest quality materials and tested to the highest standards. With rated currents from 50A to 350A with a breaking capacity of 3kA.

FEATURES

- Reliable clearing of DC fault currents
- High cycling performance
- Low watt losses
- Ultra-compact size and power density
- Breaking capacity to 3kA
- Operation as low as 300% In overload protection
- QR code marks on each fuse for traceability

APPLICATIONS

- ESS and BESS circuit protection
- Inverter Protection
- Power storage protection

AGENCY INFORMATION

- Designed to UL 248-13, ISO 20934-2019 (Type SF36)
- Manufactured under IATF 16949 quality system
- RoHS and REACH Compliant

PART NUMBER SYSTEM

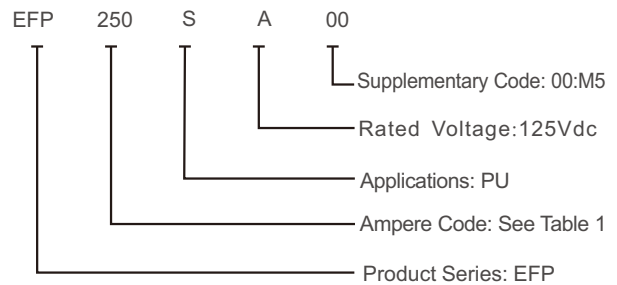

ELECTRICAL SPECIFICATIONS

Size (mm)	Part Number		Rated Current	Ampere Code	Rated Voltage	Breaking Capacity	Typical Cold Resistance(mΩ)	Typical Pre-Arcing I ² t (A ² S)
	M5 Bolt	M6 Bolt						
16x12	EFP050SA00	EFP050SA01	50 A	050	63 Vdc 100 Vdc 125 Vdc	3In-8kA@63Vdc 3In-6kA@100Vdc 3In-3kA@125Vdc	0.92	1250
	EFP060SA00	EFP060SA01	60 A	060			0.73	2230
	EFP080SA00	EFP080SA01	80 A	080			0.51	5400
	EFP100SA00	EFP100SA01	100 A	100			0.43	9600
	EFP150SA00	EFP150SA01	150 A	150			0.33	21800
	EFP200SA00	EFP200SA01	200 A	200			0.24	38500
	EFP250SA00	EFP250SA01	250 A	250			0.19	60500
	EFP300SA00	EFP300SA01	300 A	300			0.16	85000
	EFP350SA00	EFP350SA01	350 A	350	125 Vdc	3In-3kA@125 Vdc	0.13	92000

Table1 Note: (1).Typical Pre-arcing I²t are measured at 10In Current
(2).Recommend tightening torque is M6 with 5-5.5N•m; M5 with 3.5-4N•m

DIMENSIONS (mm)

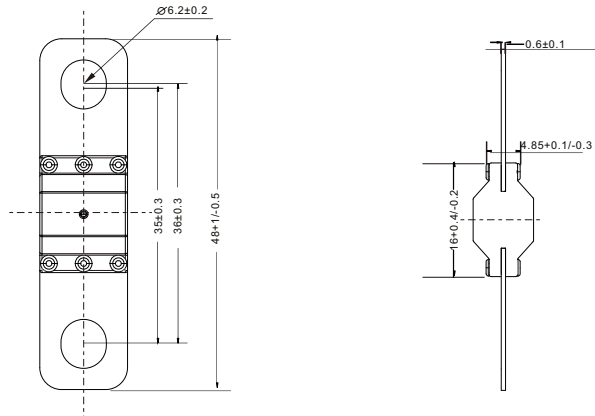

TIME VS CURRENT CHARACTERISTIC

Part Number	100 %	300 %
EFPxxxSAxx	>4h	<10s

TIME CURRENT CURVE

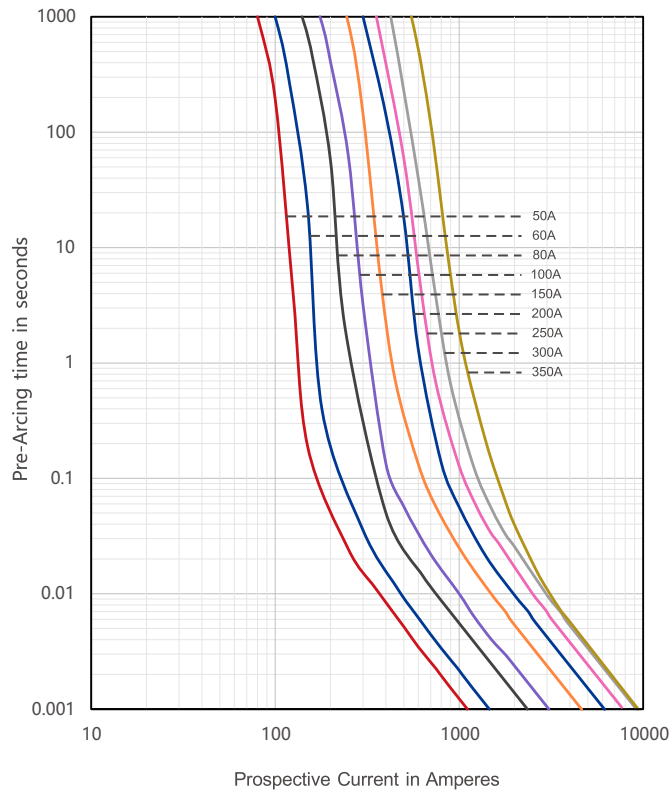

AT1 150 Vdc ESS Fuse



DESCRIPTION

Adler AT1 series ESS fuses are engineered and manufactured for use in Industrial ESS and Power Distribution Protection, made from the highest quality materials and tested to the highest standards. With rated currents from 20A – 200A with a breaking capacity of 20kA.

FEATURES

- Reliable clearing of DC fault currents
- High cycling performance
- Low watt losses
- Ultra-compact size and power density
- High breaking capacity to 20kA
- Full coverage of battery module current
- QR code marks on each fuse for traceability

APPLICATIONS

- ESS and BESS circuit protection
- Inverter Protection
- Power storage protection

AGENCY INFORMATION

- Designed to UL 248-13, UL 248-20, JASO D622
- Manufactured under IATF 16949 quality system
- RoHS and REACH Compliant

PART NUMBER SYSTEM

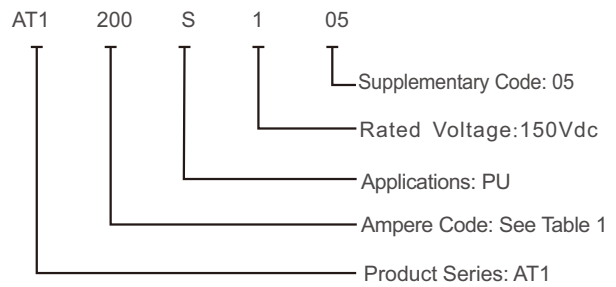

ELECTRICAL SPECIFICATIONS

Size (mm)	Part Number	Rated Current	Ampere Code	Rated Voltage	Breaking Capacity	Watt Loss(W)		Certifications
						1.0In	UL	
25x18	AT1020S105	20 A	020	150 Vdc	20 kA@150 Vdc	1.8	•	
	AT1032S105	32 A	032			3.5	•	
	AT1050S105	50 A	050			6	•	
	AT1060S105	60 A	060			7.5	•	
	AT1080S105	80 A	080			9	•	
	AT1110S105	100 A	100			11	•	
	AT1125S105	125 A	125			12.8	•	
	AT1150S105	150 A	150			16.2	•	
	AT1200S105	200 A	200			18.5	•	

Table1 Note: (1) Temperature Rise: ≤45K with 0.6In of rated current
 (2) ●=Certification obtained. UL File number:E485737

DIMENSIONS (mm)

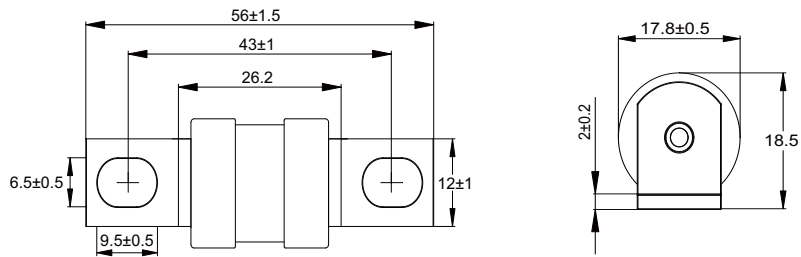

TIME CURRENT CURVE

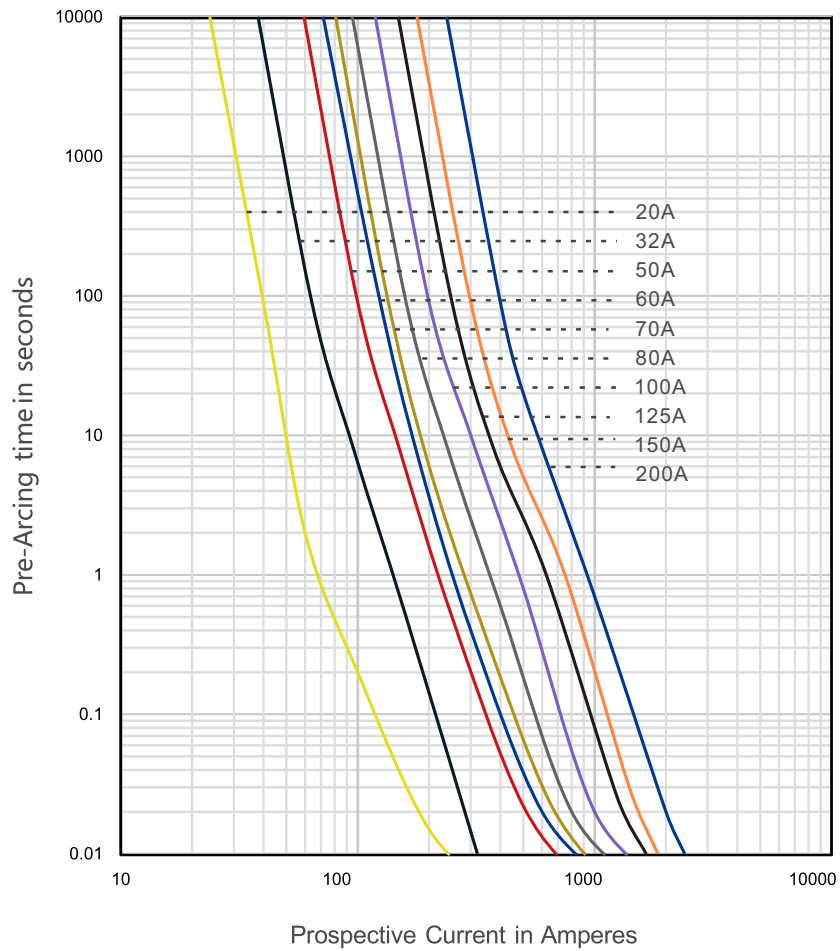

EF3 150/350 Vdc ESS Fuse



DESCRIPTION

Adler EF3 series ESS fuses are engineered and manufactured for use in Industrial ESS and Power Distribution Protection, made from the highest quality materials and tested to the highest standards. With currents from 150A - 700A with a breaking capacity of 50kA.

FEATURES

- Reliable clearing of DC fault currents
- High cycling performance
- Low watt losses
- Ultra-compact size and power density
- High breaking capacity to 50kA
- Operation as low as 410% In overload protection
- QR code marks on each fuse for traceability

APPLICATIONS

- ESS and BESS circuit protection
- Inverter Protection
- Power storage protection

AGENCY INFORMATION

- Designed to UL 248-20, ISO 8820-8, GB/T 31465
- UL Recognized Component
- Manufactured under IATF 16949 quality system
- RoHS and REACH Compliant

PART NUMBER SYSTEM

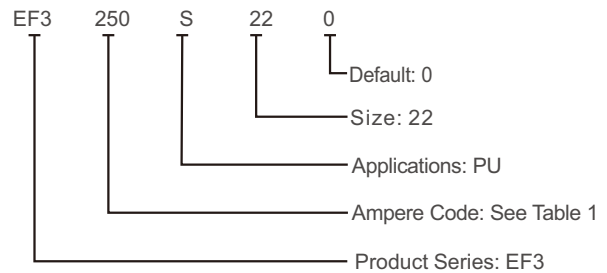

ELECTRICAL SPECIFICATIONS

Size (mm)	Part Number	Rated Current	Ampere Code	Rated Voltage	Breaking Capacity		Pre-arcing A ² sec	Wait Loss(W) 1.0In
					UL**	Self-Certified		
77X20	EF3150S220	150A	3150	200Vdc 315Vdc	4.1In~50kA@200 Vdc	6kA@315 Vdc	4500	23.1
	EF3175S220	175A	3175	200Vdc 315Vdc	4.1In~50kA@200 Vdc	6kA@315 Vdc	6600	25.2
	EF3200S220	200A	3200	200Vdc 315Vdc	4.1In~50kA@200 Vdc	6kA@315 Vdc	8500	27.5
	EF3250S220	250A	3250	200Vdc 315Vdc	4.1In~50kA@200 Vdc	6kA@315 Vdc	16000	30.5
	EF3300S220	300A	3300	200Vdc	4.1In~50kA@200 Vdc	-	29000	34.3
	EF3350S220	350A	3350	200Vdc	○	50kA@200 Vdc	31500	37.5
79X32	EF3350S370	350A	3350	250Vdc	4.1In~50kA@200 Vdc	-	28750	44.5
	EF33400S70	400A	3400	250Vdc	4.1In~50kA@200 Vdc	-	43700	45.5
	EF3450S370	450A	3450	250Vdc	4.1In~50kA@200 Vdc	-	56350	57.0
	EF3500S370	500A	3500	250Vdc	4.1In~50kA@200 Vdc	-	67600	61.3
77X30	EF3600S37A	600A	3600	150Vdc	○	50kA@200 Vdc	82000	66.0
	EF3700S37A	700A	3700	150Vdc	○	50kA@200 Vdc	128000	75.0

Table1 1. ** = UL File: E506668
2. ○ = UL certification in process

DIMENSIONS (mm)

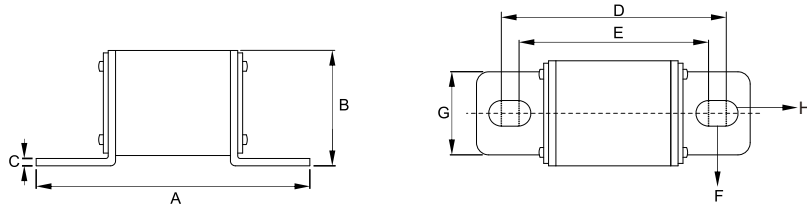

Fuse Size	A	B	C	D	E	F	G	H
36X22	77±1	25.0±1	2.0	62.0±0.8	49.5±0.8	6.25±0.8	20.0±0.5	Φ 8.5±0.5
79X32	79±1	24.0±1	2.0	62.5±0.8	49.5±1.0	6.5±0.8	32.3±1.0	Φ 8.5±0.5
77X30	77±1	31.8±1	2.0	59.0±0.8	51.0±1.0	4.0±1.0	30.0±0.5	Φ 8.5±0.5

Table2

TIME CURRENT CURVE

EF3xxxx220

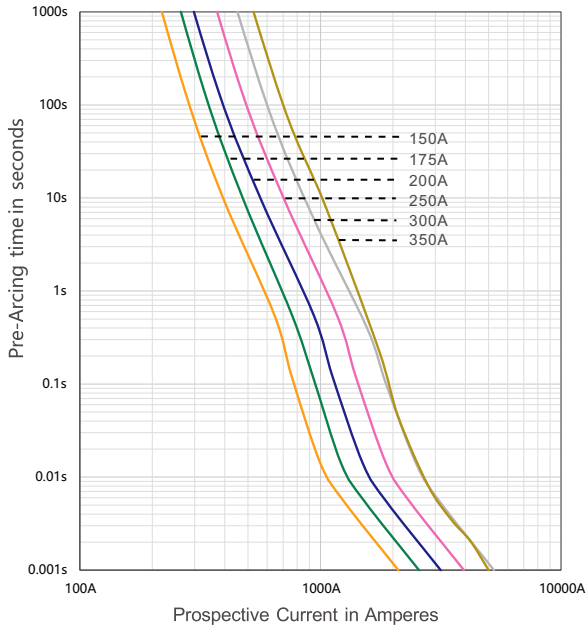

EF3xxxx370

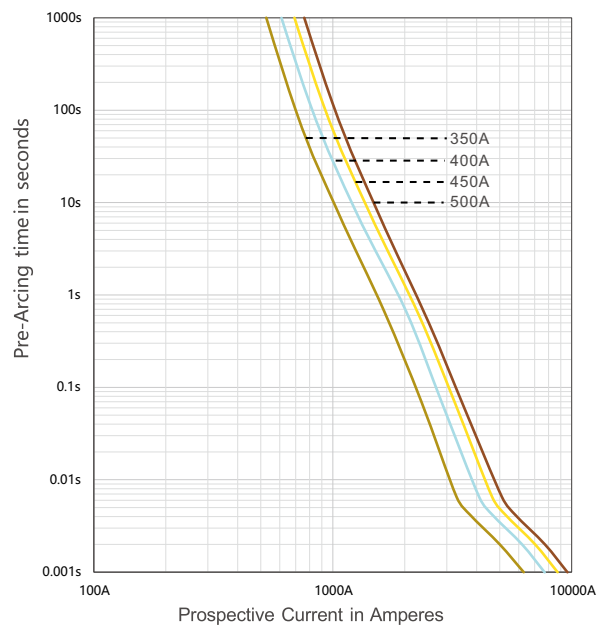

EF3xxxx37A

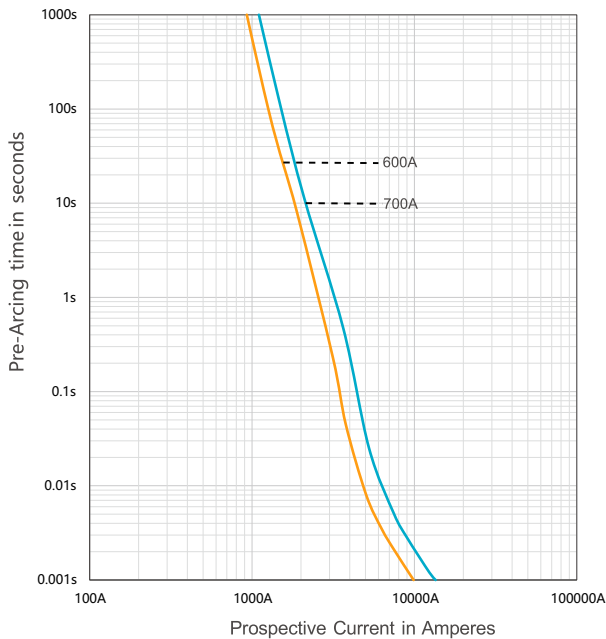

AB1 200 Vdc ESS Fuse



DESCRIPTION

Adler AB1 series ESS fuses are engineered and manufactured for use in Industrial ESS and Power Distribution Protection, made from the highest quality materials and tested to the highest standards. With rated currents from 50A to 300A with a breaking capacity of 20kA.

FEATURES

- 200 VDC fuse
- Rated Current: 50-300 A
- Breaking Capacity: 20 kA
- Dimensions: 22x29mm
- Mounting choices: Level Mount and Central Mount

APPLICATIONS

- ESS and BESS circuit protection
- Power storage protection

AGENCY INFORMATION

- Approvals: UL (E485737)
- Ref. to: UL 248-13; IEC 60269-4

PART NUMBER SYSTEM

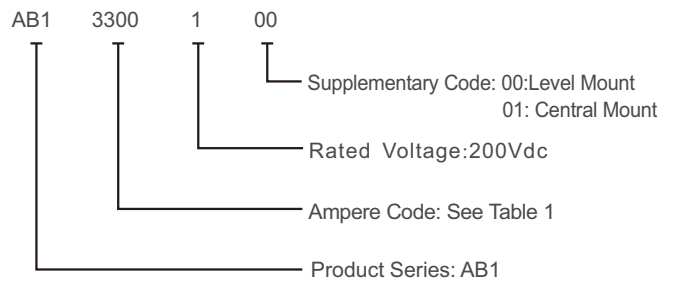

ELECTRICAL SPECIFICATIONS

Part Number		Rated Current	Ampere Code	Rated Voltage	Breaking Capacity	Dissipation(W)	Certifications
Level Mount	Central Mount					1.0In	UL
AB12500100	AB12500101	50 A	2500	200 Vdc	20 kA@200 Vdc	6.5	•
AB12600100	AB12600101	60 A	2600			9.0	•
AB12700100	AB12700101	70 A	2700			12.0	•
AB12800100	AB12800101	80 A	2800			12.5	•
AB13100100	AB13100101	100 A	3100			13.5	•
AB13125100	AB13125101	125 A	3125			25.0	•
AB13150100	AB13150101	150 A	3150			26.0	•
AB13200100	AB13200101	200 A	3200			30.0	•
AB13300100	AB13300101	300 A	3300			45.0	•

Table1 Note: (1) Operation Temperature Range: -40°C to +125°C
(2) ●=Certification obtained. UL File number: E585737

DIMENSIONS (mm)

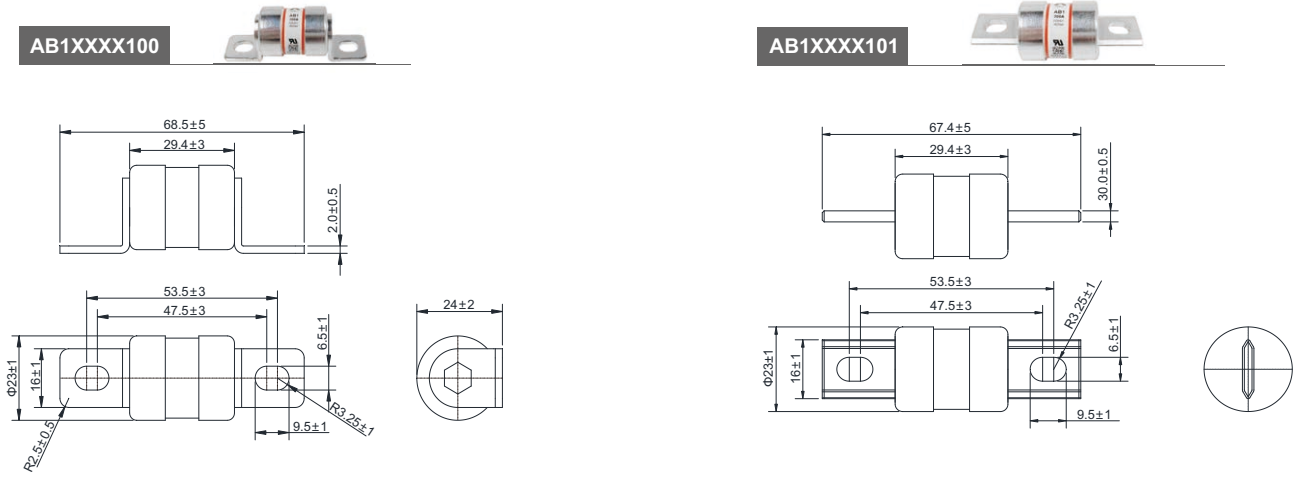

TIME CURRENT CURVE

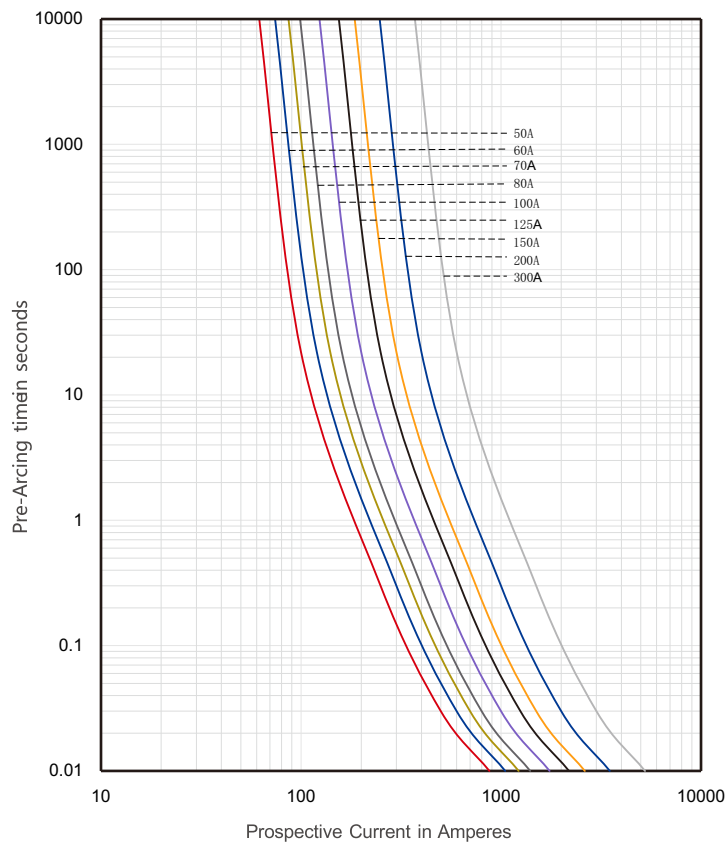

AT2 250Vdc ESS Fuse

RoHS



DESCRIPTION

Adler AT2 series ESS fuses are engineered and manufactured for use in Industrial ESS and Power Distribution Protection, made from the highest quality materials and tested to the highest standards. With rated currents from 200A to 500A with a breaking capacity of 10kA.

FEATURES

- Reliable clearing of DC fault currents
- High cycling performance
- Low watt losses
- Ultra-compact size and power density
- High breaking capacity to 10kA
- Full coverage of battery module current
- QR code marks on each fuse for traceability

APPLICATIONS

- ESS and BESS circuit protection
- Inverter Protection
- Power storage protection

AGENCY INFORMATION

- Designed to UL 248-13, UL 248-20, JASO D622
- Manufactured under IATF 16949 quality system
- RoHS and REACH Compliant

PART NUMBERING SYSTEM

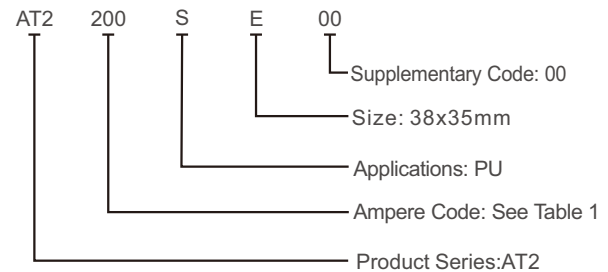

ELECTRICAL SPECIFICATIONS

Size (mm)	Part Number	Rated Current	Ampere Code	Rated Voltage	Breaking Capacity	1.0 In Dissipation (W)
38x35	AT2200SE00	200 A	3200	250 Vdc	10 kA@250 Vdc	35
	AT2250SE00	250 A	3250			37
	AT2300SE00	300 A	3300			40
	AT2350SE00	350 A	3350			45
	AT2400SE00	400 A	3400			49
	AT2450SE00	450 A	3450			67
	AT2500SE00	500 A	3500			75

Table1 Note: (1) Temperature rise: <50 K.

DIMENSIONS (mm)

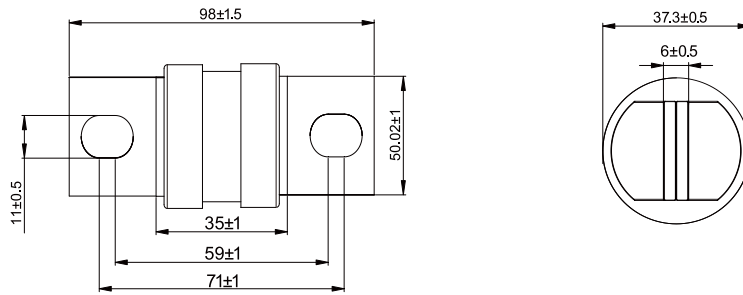

TIME VS CURRENT CHARACTERISTIC

Rated Current	200 %	300 %	500 %
200-500A	1-300s	0.2-30s	0.1-10s

TIME CURRENT CURVE

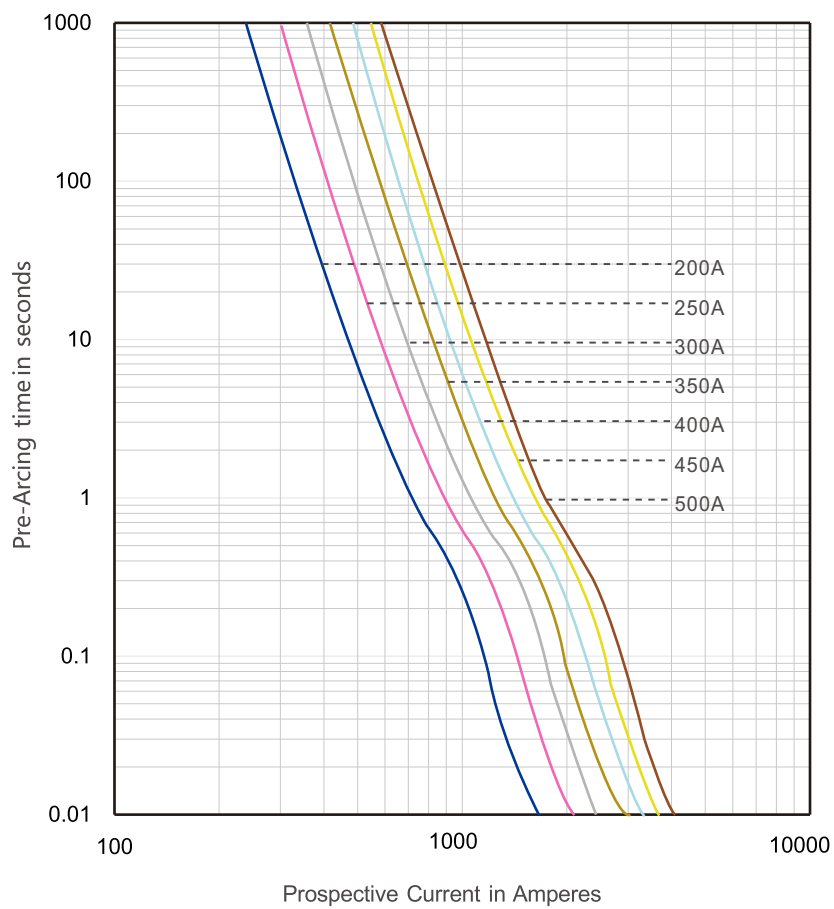

EF5 500 Vdc ESS Fuse



DESCRIPTION

Adler EF5 series ESS fuses are engineered and manufactured for use in Industrial ESS and Power Distribution Protection, made from the highest quality materials and tested to the highest standards. With currents from 100A – 400A with a breaking capacity of 50kA.

FEATURES

- Reliable clearing of DC fault currents
- High cycling performance
- Low watt losses
- Ultra-compact size and power density
- High breaking capacity to 50kA
- Operation as low as 410% In overload protection
- QR code marks on each fuse for traceability

AGENCY INFORMATION

- Designed to UL 248-20
- UL Recognized Component
- Manufactured under IATF 16949 quality system
- RoHS and REACH Compliant

APPLICATIONS

- ESS and BESS circuit protection
- Inverter Protection
- Power storage protection

PART NUMBERING SYSTEM

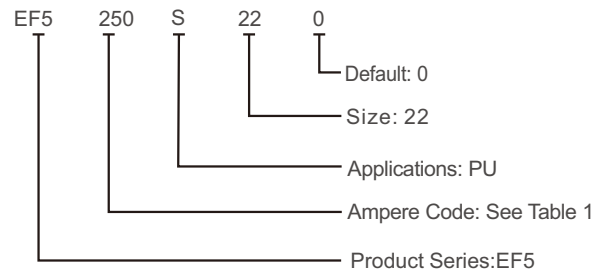

ELECTRICAL SPECIFICATIONS

Size(mm)	Part Number	Rated Current	Ampere Code	Rated Voltage	Breaking Capacity (UL **)	I ² T(A ² sec)		Watt Loss(W)
						Pre-arcing	Total @ 500Vdc	1.0 In
49x22	EF5100S220	100 A	100	500 Vdc	5.1In~50 kA	1770	7020	14.9
	EF5125S220	125A	125			2850	11500	19.3
	EF5150S220	150 A	150			4150	15770	23.1
	EF5175S220	175 A	175			5970	22850	27.5
	EF5200S220	200 A	200			9350	36500	30.8
	EF5250S220	250 A	250			16600	67800	35.2
49x36	EF5300S370	300 A	300	500 Vdc	5.1In~50 kA	20500	67500	7.1
	EF5350S370	350 A	350			32600	107580	7.85
	EF5400S370	400 A	400			42250	148000	9.8

Table1 1. ** --- UL File: E506668
2. Recommend mounting torque is 12+/-1.0Nm (M8)

DIMENSIONS (mm)

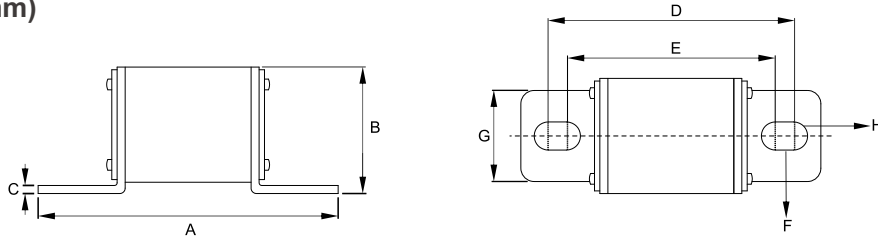

Size	A	B	C	D	E	F	G	H
49x22	90±1	25±1	2±0.1	75±0.1	62.5±0.8	12.5	20±0.5	∅ 8.5±0.5
49x36	92±1.5	24±1	2±0.1	75.5±0.1	62.5±1	13	32.5±0.5	∅ 8.5±0.5

Table2

TIME CURRENT CURVE

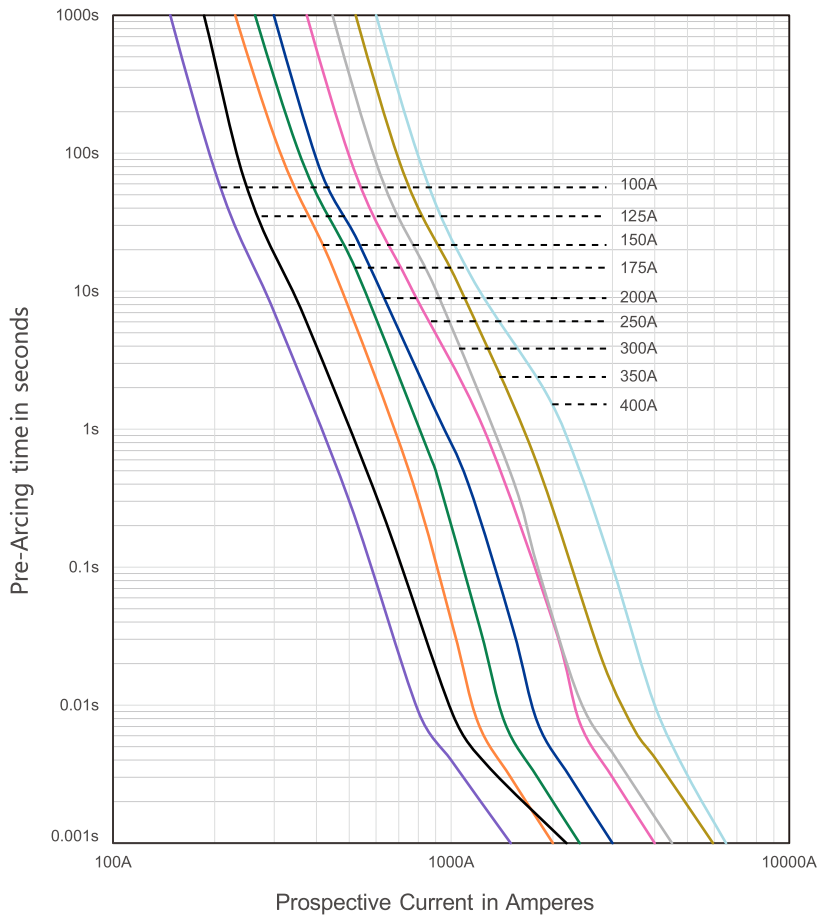

EF8 800 Vdc ESS Fuse



DESCRIPTION

Adler EF8 series ESS fuses are engineered and manufactured for use in Industrial ESS and Power Distribution Protection, made for the highest quality materials and tested to the highest standards. With rated currents from 100A to 400A with a breaking capacity of 20kA.

FEATURES

- Reliable clearing of DC fault currents
- High cycling performance
- Low watt losses
- Ultra-compact size and power density
- High breaking capacity to 20kA
- QR code marks on each fuse for traceability

AGENCY INFORMATION

- Designed to UL 248-20, IEC 60269-4
- UL Recognized Component
- Manufactured under IATF 16949 quality system
- RoHS and REACH Compliant

APPLICATIONS

- ESS and BESS circuit protection
- Inverter Protection
- Power storage protection

PART NUMBERING SYSTEM

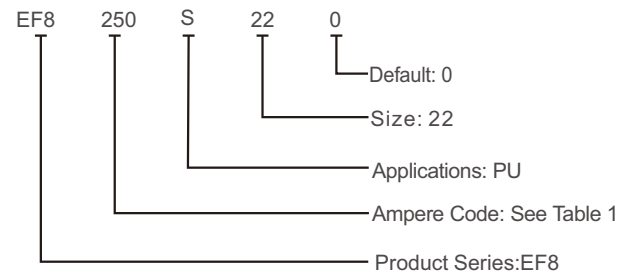

ELECTRICAL SPECIFICATIONS

Size(mm)	Part Number	Rated Current	Ampere Code	Rated Voltage	Breaking Capacity(UL ^{**})	I ² T(A ² sec)		Watt Loss(W)	
						Pre-arcing	Total @ 800Vdc	0.5 In	1.0 In
98x22	EF8100S80L	100 A	100	800 Vdc	6In~20 kA	990	5120	6	21
	EF8125S80L	125A	125			1650	8910	4	23
	EF8150S80L	150A	150			2750	16500	7	25
	EF8160S80L	160 A	160			11000	-	5.1	29.5
	EF8200S80L	200 A	200			6200	41500	7.5	30
	EF8250S80L	250 A	250			11000	75000	-	37
100x36	EF8250S81L	250 A	250	800 Vdc	6In~20 kA	8900	50700	9.5	48
	EF8315S81L	315 A	315			12500	73000	11.3	60
	EF8350S81L	350 A	500			18500	115000	15.1	65
	EF8400S81L	400 A	400			26500	172000	17.4	72

Table1 1. ** --- UL File: E506668
2. Recommend mounting torque is 12+/-1.0Nm (M8)

DIMENSIONS (mm)

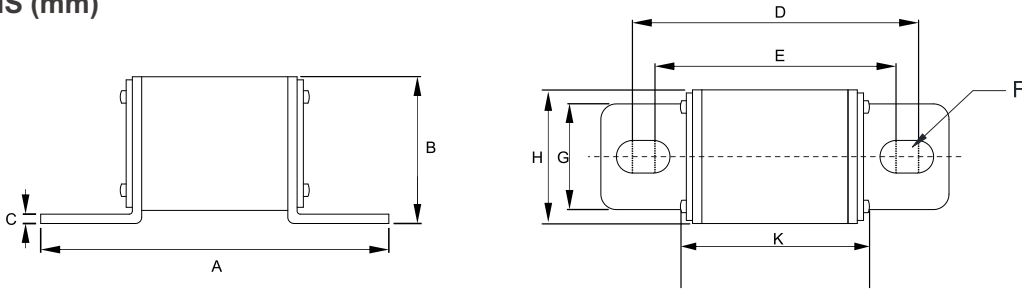

Part Number	A±1	B±1	C	D±1	E±1	F	G±0.5	H	K±3
EF8xxxS80L	98	25.0	2±0.2	83	70.5	Φ 8.5	20.0	22±0.8	57
EF8xxxS81L	100	24.0	2±0.1	83	71	Φ 10.5	32.5	36.3+1.2/-0.5	57

Table2

TIME CURRENT CURVE

EF8xxxS80L 100A-200A

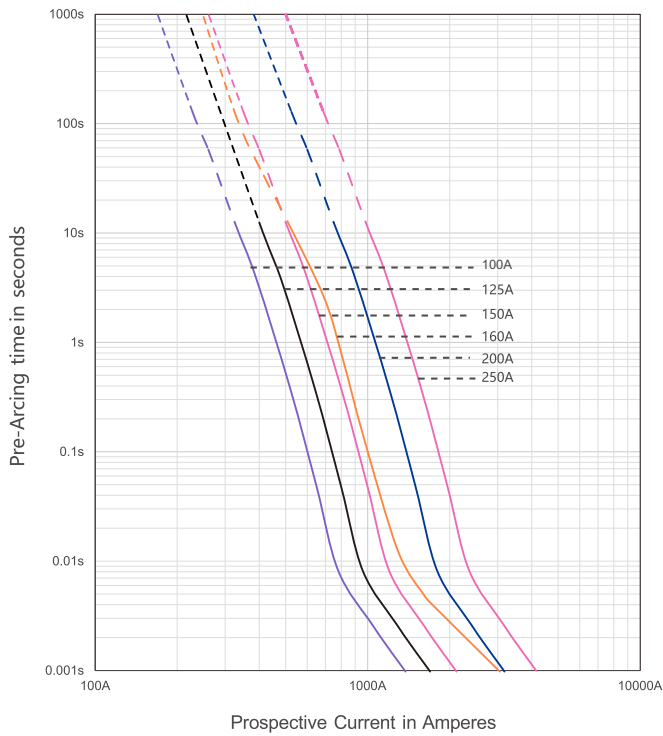

EF8xxxS81L 250A-400A

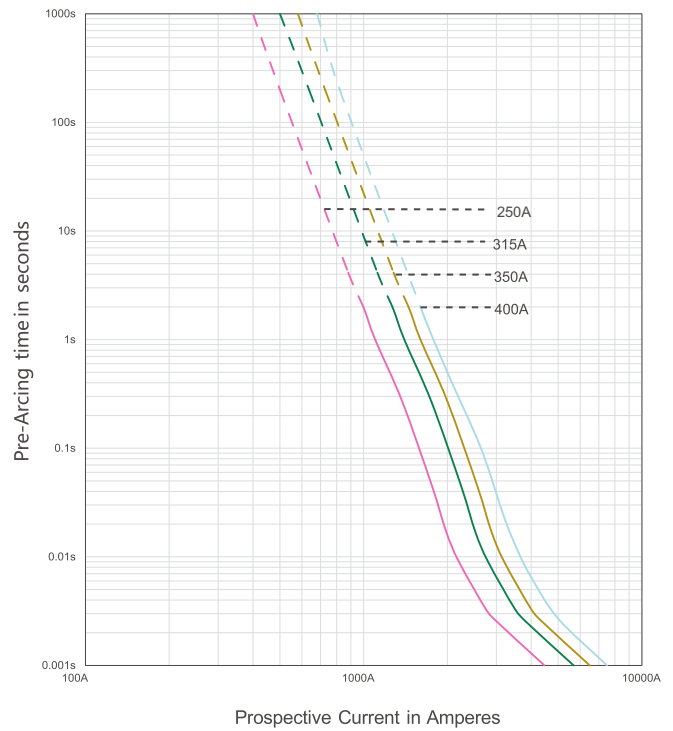

AT7 800 Vdc ESS Fuse

RoHS



DESCRIPTION

Adler AT7 series ESS fuses are engineered and manufactured for use in Industrial ESS and Power Distribution Protection, made from the highest quality materials and tested to the highest standards. With rated currents from 125A to 400A with a breaking capacity of 20kA.

FEATURES

- Reliable clearing of DC fault currents
- High cycling performance
- Low watt losses
- Ultra-compact size and power density
- High breaking capacity to 50kA
- QR code marks on each fuse for traceability

APPLICATIONS

- ESS and BESS circuit protection
- Power Storage Protection

AGENCY INFORMATION

- Designed to UL 248-20, UL 248-13
- Manufactured under IATF 16949 quality system
- RoHS and REACH Compliant

PART NUMBER SYSTEM

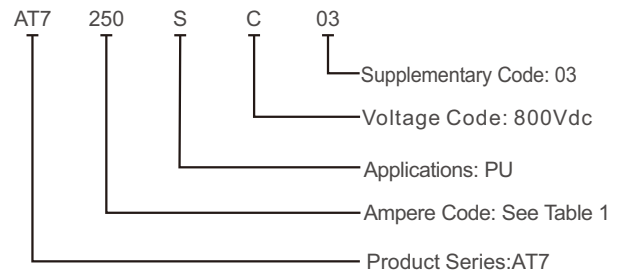

ELECTRICAL SPECIFICATIONS

Size (mm)	Part Number	Rated Current	Ampere Code	Rated Voltage	Breaking Capacity	Dissipation (W) 1.0 In
38x70	AT7125SC03	125 A	125	800 Vdc	20 kA@800 Vdc	23
	AT7150SC03	150 A	150			32
	AT7200SC03	200 A	200			42
	AT7250SC03	250 A	250			45
	AT7300SC03	300 A	300			50
	AT7350SC03	350 A	350			65
	AT7400SC03	400 A	400			71

Table1 Note: 1. Temperature rise: 0.5In<45K.
2. Recommend tightening torque is 20±1.0Nm (M10).

DIMENSIONS(mm)

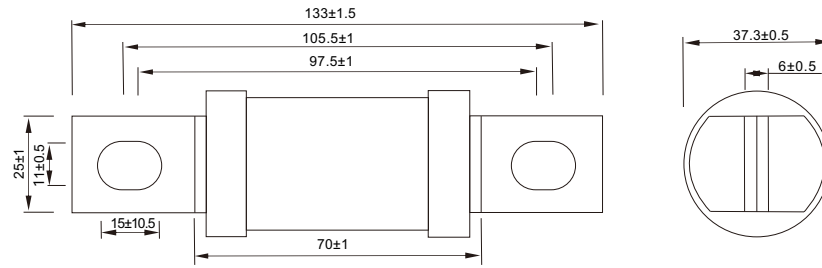

TIME CURRENT CURVE

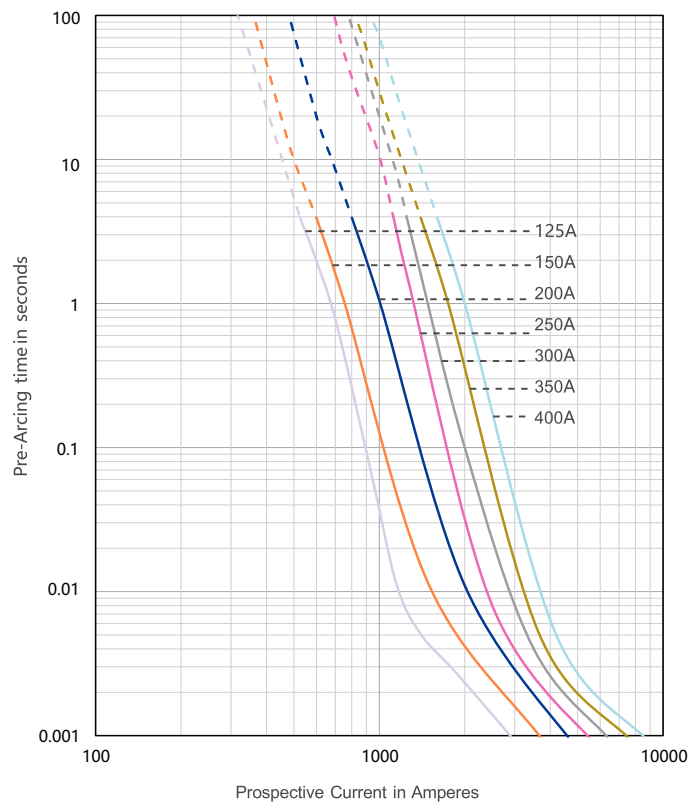

AT8 800 Vdc ESS Fuse



DESCRIPTION

Adler AT8 series ESS fuses are engineered and manufactured for use in Industrial ESS and Power Distribution Protection, made from the highest quality materials and tested to the highest standards. With rated currents from 50A to 200A with a breaking capacity of 20kA.

FEATURES

- Reliable clearing of DC fault currents
- High cycling performance
- Low watt losses
- Ultra-compact size and power density
- High breaking capacity to 20kA
- QR code marks on each fuse for traceability

APPLICATIONS

- ESS and BESS circuit protection
- Power Storage Protection

AGENCY INFORMATION

- Designed to UL 248-20, UL 248-13
- Manufactured under IATF 16949 quality system
- RoHS and REACH Compliant

PART NUMBER SYSTEM

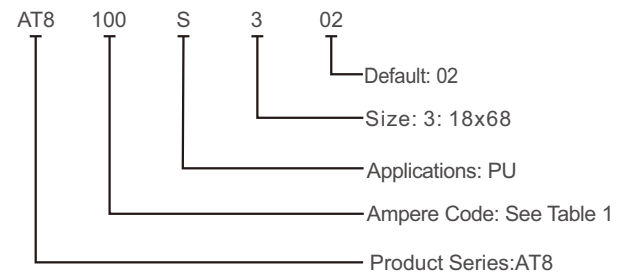

ELECTRICAL SPECIFICATIONS

Size(mm)	Part Number	Rated Current	Ampere Code	Rated Voltage	Breaking Capacity	I ² t (A ² sec)	Watt Loss(W)	Certifications
							1.0I _n	UL
18x68	AT8050S302	50 A	050	800 Vdc	10kA@800 Vdc	8500	9.5	•
	AT8060S302	60 A	060			12000	12	•
	AT8070S302	70 A	070			21000	13	•
	AT8080S302	80 A	080			25000	15	•
	AT8100S302	100 A	100			50000	18	•
30x65	AT8125S302	125 A	125	800 Vdc	20kA@800 Vdc	5780	-	•
	AT8150S302	150 A	150			8850	-	•
	AT8175S302	175 A	175			12250	-	•
	AT8200S302	200 A	200			16000	-	•

Table1 Note: (1)•=Certification obtained. UL File number:E485737
 (2)AT8xxx302 and AT8xxx702 recommend mounting torque is 12±1.0Nm (M8);
 (3)Temperature rise: AT8xxx302 with 0.6In ≤45K; AT8xxx702 with 0.5In ≤ 45K.

DIMENSIONS (mm)

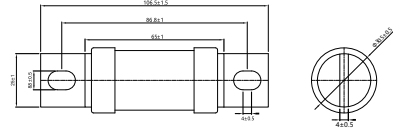
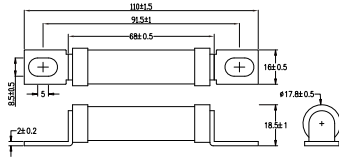

TIME VS CURRENT CHARACTERISTIC

Part Number	100 %	200 %	300 %	500 %
AT8xxx302 AT8xxx702	>4h	1-300s	0.2-30S	0.1-10S

TIME CURRENT CURVE

AT8xxx302

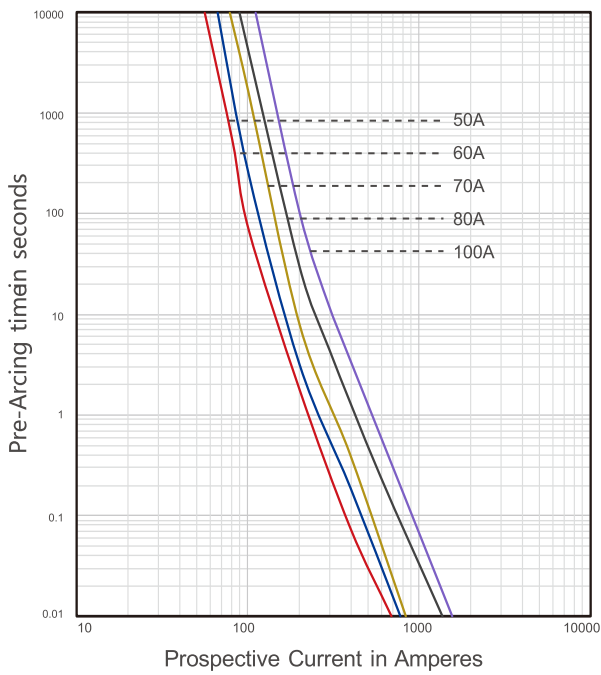

AT8xxx702

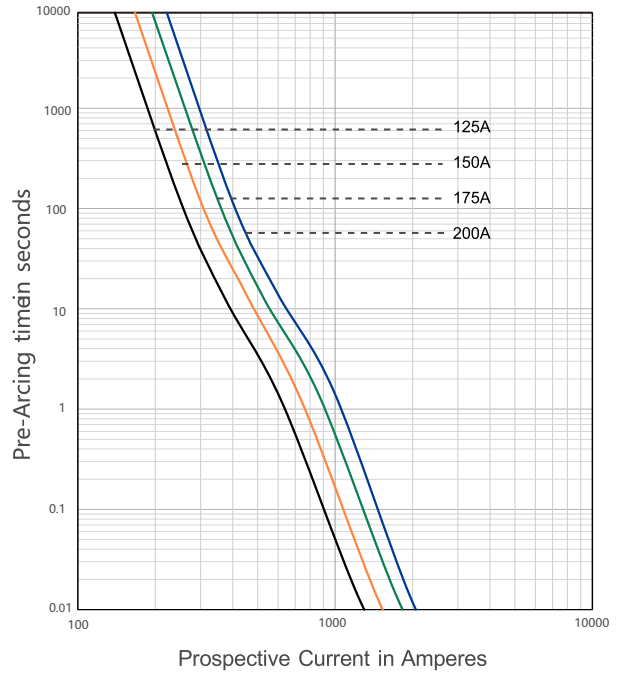

EFX 1000 Vdc ESS Fuse



DESCRIPTION

Adler EFX series ESS fuses are engineered and manufactured for use in Industrial ESS and Power Distribution Protection, made for the highest quality materials and tested to the highest standards. With rated currents from 63A to 500A with a breaking capacity of 50kA.

FEATURES

- Reliable clearing of DC fault currents
- High cycling performance
- Low watt losses
- Ultra-compact size and power density
- High breaking capacity to 50kA
- QR code marks on each fuse for traceability

APPLICATIONS

- ESS and BESS circuit protection
- Inverter Protection
- Power storage protection

AGENCY INFORMATION

- Designed to JASO D622, UL 248-20, IEC 60269-4
- UL Recognized Component
- Manufactured under IATF 16949 quality system
- RoHS and REACH Compliant

PART NUMBER SYSTEM

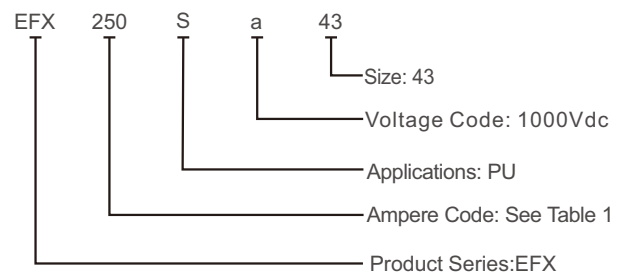

ELECTRICAL SPECIFICATIONS

Size(mm)	Part Number	Rated Current	Ampere Code	Rated Voltage	Breaking Capacity		I ² t (A ² sec)		Watt Loss (W)
					UL**	Self -Certified	Pre-arcing	Total@1000Vdc	0.5In
74x22	EFX063Sa22	63A	063	1000 Vdc	-	4In~50kA	720	4360	2.6
	EFX080Sa22	80A	080	1000 Vdc	-	4In~50kA	1050	6710	3.2
	EFX100Sa22	100A	100	1000 Vdc	-	4In~50kA	1560	10500	3.9
	EFX125Sa22	125A	125	1000 Vdc	-	4In~50kA	3200	22600	4.5
	EFX160Sa22	160A	160	1000 Vdc	-	4In~50kA	5400	43200	5.7
	EFX175Sa22	175A	175	1000 Vdc	-	4In~50kA	6250	50000	6.9
74x36	EFX150Sa36	150A	150	1000 Vdc	-	4In~50kA	4630	23300	4.5
	EFX200Sa36	200A	200	1000 Vdc	-	4In~50kA	8300	43900	6.6
	EFX250Sa36	250A	250	1000 Vdc	-	4In~50kA	13300	75600	8.5
71x47	EFX200Sa43	200A	200	1000 Vdc	4In~50kA	-	5300	26800	7.9
	EFX250Sa43	250A	250	1000 Vdc	4In~50kA	-	9600	49980	10.3
	EFX300Sa43	300A	300	1000 Vdc	4In~50kA	-	13200	69300	12.7
	EFX350Sa43	350A	350	1000 Vdc	4In~50kA	-	21600	115000	14.5
	EFX400Sa43	400A	400	1000 Vdc	4In~50kA	-	28600	163000	17
	EFX450Sa43	450A	450	1000 Vdc	4In~50kA	-	38200	223000	19.5
	EFX500Sa43	500A	500	1000 Vdc	-	4In~50kA	49600	294000	21

Table1 Note: 1. ** -- UL File: E506668
 2. EFXxxxSa22, EFXxxxSa43 temperature rise: 0.5In < 50K.
 3. EFXxxxSa22 and EFXxxxSa36 recommended mounting torque is 12+/-1.0Nm (M8);
 4. EFXxxxx43 recommended mounting torque is 20+/-1Nm (M10).

DIMENSIONS(mm)

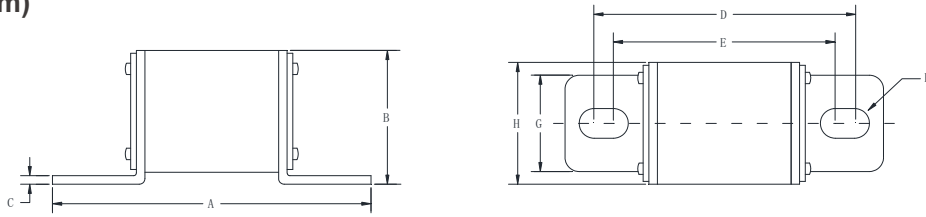

Part Number	A	B	C	D	E	F	G	H
EFXxxxSa22	115±1.5	25±1.5/-0.5	2±0.1	100±1	87.5±1	Φ8.5±0.3	20±0.5	22+0.8/-0.5
EFXxxxSa36	117±1.5	24±1	2±0.1	100.5±1	87.5±1	Φ8.5±0.5	32.5±0.5	36.3+1.2/-0.5
EFXxxxSa43	126.5±1.5	48±0.8	3±0.15	106±1	89±1	Φ10.5±0.3	34.0±0.5	47.0±0.5

Table2

TIME CURRENT CURVE

EFXxxxSa22 63A-175A

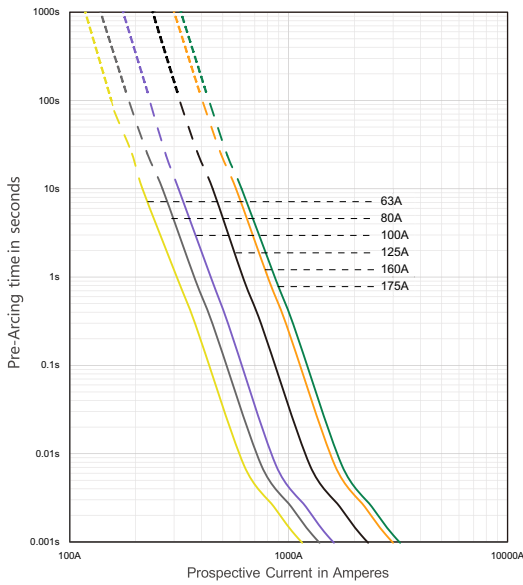

EFXxxxSa36 250A

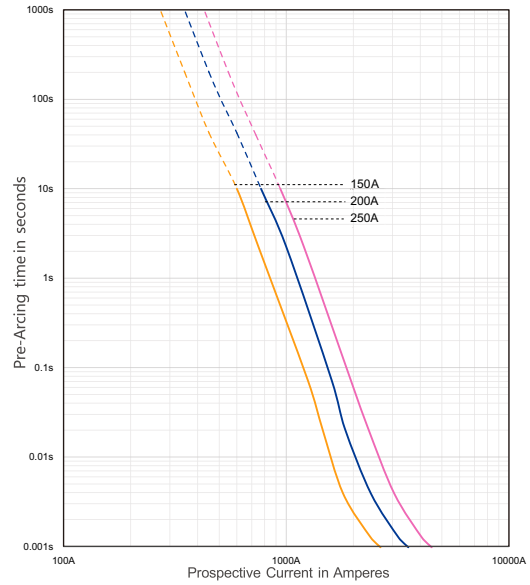

EFXxxxSa43 200-500A

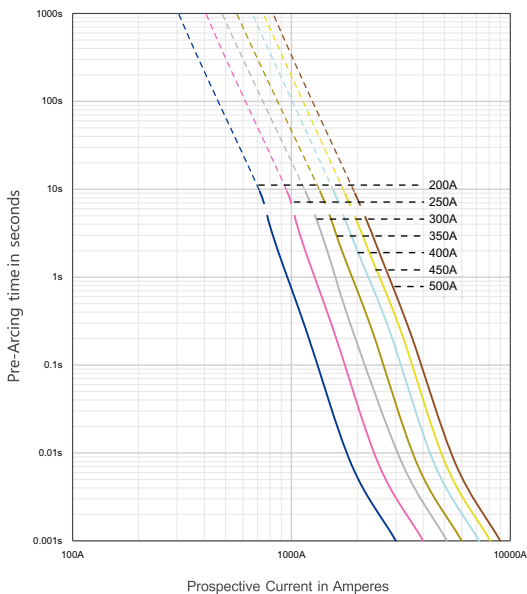

ATX 1000 Vdc ESS Fuse



DESCRIPTION

Adler ATX series ESS fuses are engineered and manufactured for use in Industrial ESS and Power Distribution Protection, made from the highest quality materials and tested to the highest standards. With rated currents from 160A to 800A with a breaking capacity of 50kA.

FEATURES

- Reliable clearing of DC fault currents
- High cycling performance
- Low watt losses
- Ultra-compact size and power density
- High breaking capacity to 50kA
- Full coverage of battery module current
- Low costs
- QR code marks on each fuse for traceability

APPLICATIONS

- ESS and BESS circuit protection
- Inverter Protection
- Power storage protection

AGENCY INFORMATION

- Designed to IEC60269, UL248
- Manufactured under IATF 16949 quality system
- RoHS and REACH Compliant

PART NUMBER SYSTEM

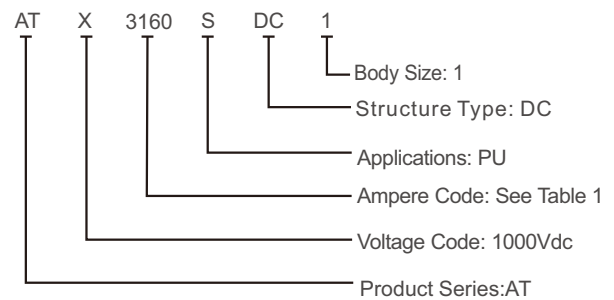

ELECTRICAL SPECIFICATIONS

Size(mm)	Part Number	Rated Current	Rated Voltage	Breaking Capacity		Pre-arcing I ² t (A ² s)	Clearing I ² t (A ² s)	Watt Loss (W) In
				UL**	Self-Certified			
1	ATX3160SDC1	160A	1000 Vdc	-	50kA	2000	12100	45
	ATX3200SDC1	200A	1000 Vdc	-	50kA	3950	23400	50
	ATX3250SDC1	250A	1000 Vdc	-	50kA	9500	56000	60
	ATX3315SDC1	315A	1000 Vdc	-	50kA	15000	90000	65
	ATX3350SDC1	350A	1000 Vdc	-	50kA	21500	134000	70
	ATX3400SDC1	400A	1000 Vdc	-	50kA	29500	175000	75
	ATX3450SDC1	450A	1000 Vdc	-	50kA	43000	256000	80
	ATX3500SDC1	500A	1000 Vdc	-	50kA	70000	342000	86
	ATX3550SDC1	550A	1000 Vdc	-	50kA	96000	470000	95
	ATX3630SDC1	630A	1000 Vdc	-	50kA	130000	660000	100
2	ATX3250SDC2	250A	1000 Vdc	-	50kA	11500	68000	60
	ATX3315SDC2	315A	1000 Vdc	-	50kA	19600	116000	65
	ATX3350SDC2	350A	1000 Vdc	-	50kA	22000	126000	70
	ATX3400SDC2	400A	1000 Vdc	-	50kA	31500	188000	75
	ATX3450SDC2	450A	1000 Vdc	-	50kA	43500	258000	80
	ATX3500SDC2	500A	1000 Vdc	-	50kA	70000	415000	86
	ATX3550SDC2	550A	1000 Vdc	-	50kA	96000	478000	96
	ATX3630SDC2	630A	1000 Vdc	-	50kA	129000	645000	99
	ATX3700SDC2	700A	1000 Vdc	-	50kA	160000	790000	124
	ATX3800SDC2	800A	1000 Vdc	-	50kA	245000	1250000	130

Table1 Note: 1.Time constant: 2 ± 0.5ms

DIMENSIONS (mm)

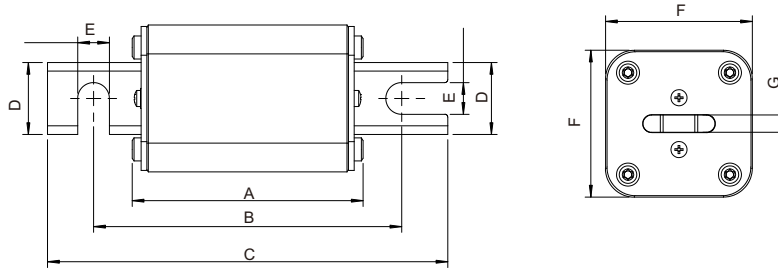

Size	A±1	B±2	C±3	D±1	E±0.5	F±1.5	G±0.5
1	80	107	139	25	11	51	6
2	80	107	139	32	11	59	6

Table2

TIME CURRENT CURVE

ATXxxxxxDC1

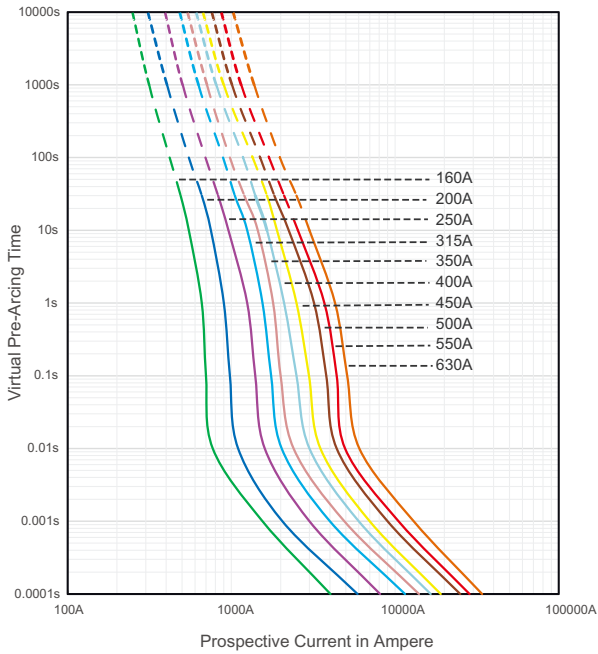

ATXxxxxxDC2

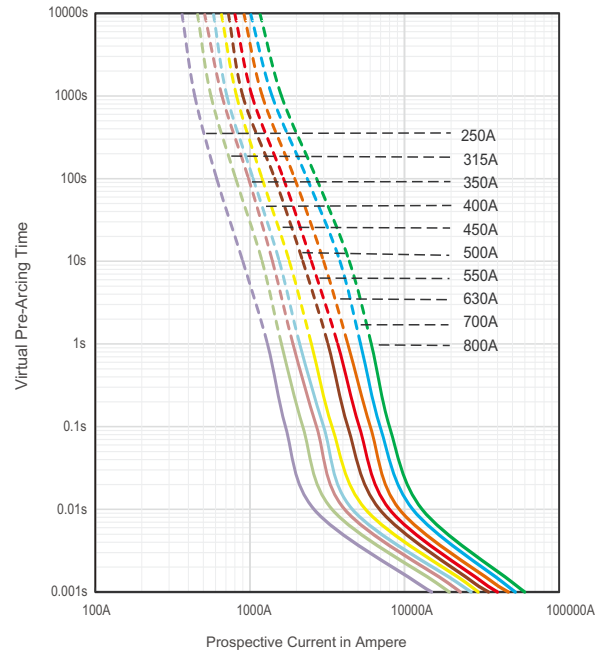

ATX 1000 Vdc/800 Vdc ESS Fuse

RoHS



DESCRIPTION

Adler ATX series ESS fuses are engineered and manufactured for use in Industrial ESS and Power Distribution Protection, made from the highest quality materials and tested to the highest standards. With rated currents from 315A to 1400A with a breaking capacity of 50kA.

FEATURES

- Reliable clearing of DC fault currents
- High cycling performance
- Low watt losses
- Ultra-compact size and power density
- High breaking capacity to 50kA
- Full coverage of battery module current
- Low costs
- QR code marks on each fuse for traceability

APPLICATIONS

- ESS and BESS circuit protection
- Inverter Protection
- Power storage protection

AGENCY INFORMATION

- Designed to IEC 60269, UL248
- Manufactured under IATF 16949 quality system
- RoHS and REACH Compliant

PART NUMBER SYSTEM

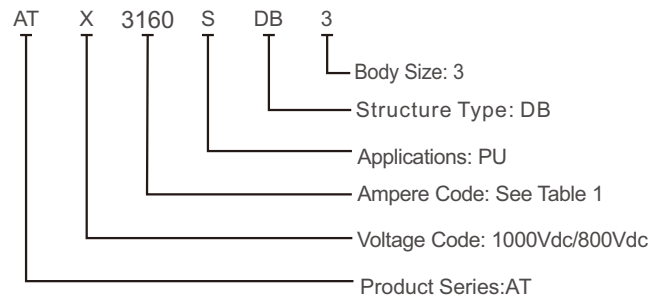

ELECTRICAL SPECIFICATIONS

Size(mm)	Part Number		Rated Current	Rated Voltage	Breaking Capacity		Pre-arcing I ² t (A ² s)	Clearing I ² t (A ² s)	Watt Loss (W) In
	Din	Flush			TUV	Self-Certified			
3	ATX3315SDB3	ATX3315SFL3	315A	1000 Vdc	-	50kA	9700	59500	85
	ATX3350SDB3	ATX3350SFL3	350A	1000 Vdc	-	50kA	14000	84500	90
	ATX3400SDB3	ATX3400SFL3	400A	1000 Vdc	-	50kA	20000	123000	95
	ATX3450SDB3	ATX3450SFL3	450A	1000 Vdc	-	50kA	32000	191000	100
	ATX3500SDB3	ATX3500SFL3	500A	1000 Vdc	-	50kA	40000	241000	105
	ATX3550SDB3	ATX3550SFL3	550A	1000 Vdc	-	50kA	56500	334000	110
	ATX3630SDB3	ATX3630SFL3	630A	1000 Vdc	-	50kA	84000	498000	115
	ATX3700SDB3	ATX3700SFL3	700A	1000 Vdc	-	50kA	115500	708000	120
	ATX3800SDB3	ATX3800SFL3	800A	1000 Vdc	-	50kA	206000	1226000	125
	ATX3900SDB3	ATX3900SFL3	900A	1000 Vdc	-	50kA	309000	1520000	130
	ATX4100SDB3	ATX4100SFL3	1000A	1000 Vdc	-	50kA	458000	2188000	135
	ATX4110SDB3	ATX4110SFL3	1100A	1000 Vdc	-	50kA	577000	2809000	140
	ATX4125SDB3	ATX4125SFL3	*1250A	800 Vdc	-	50kA	813000	3951000	145
	ATX4140SDB3	ATX4140SFL3	*1400A	800 Vdc	-	50kA	1251000	2315000	150

Table1 Note: 1.* 800VDC
2.Time constant: 2 ± 0.5ms

DIMENSIONS (mm):

ATXxxxxSDB3:

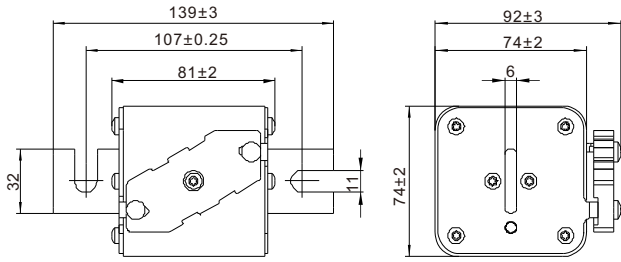

ATXxxxxSFL3:

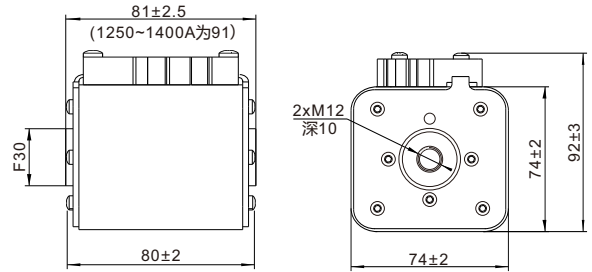

TIME CURRENT CURVE

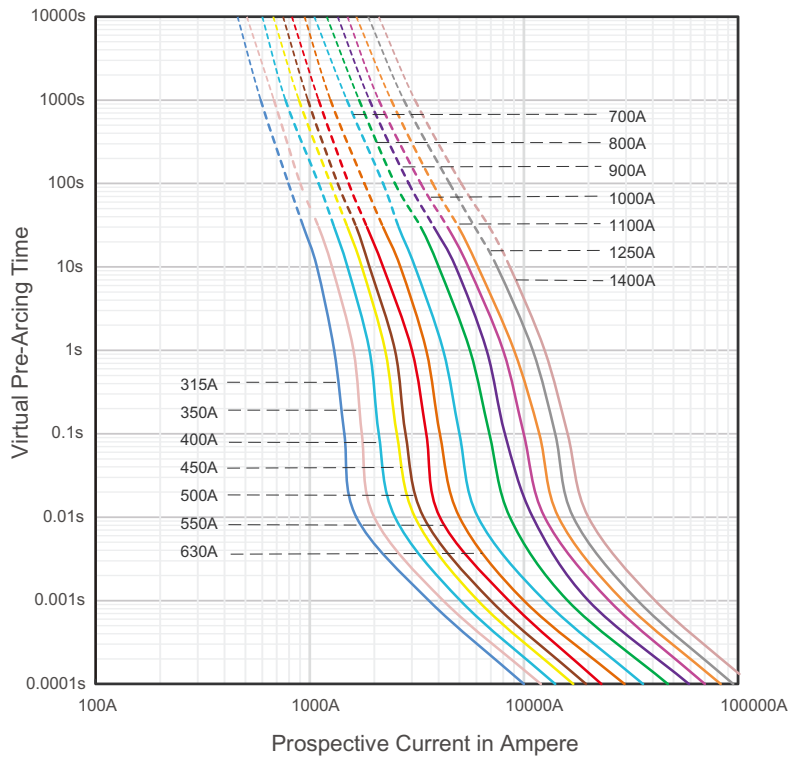

EFZ 1500 Vdc ESS Fuse

RoHS



DESCRIPTION

Adler EFZ series ESS fuses are engineered and manufactured for use in Industrial ESS and Power Distribution Protection, made from the highest quality materials and tested to the highest standards. With rated currents from 100A to 300A with a breaking capacity of 30kA.

FEATURES

- Reliable clearing of DC fault currents
- High cycling performance
- Low watt losses
- Ultra-compact size and power density
- High breaking capacity to 30kA
- QR code marks on each fuse for traceability

APPLICATIONS

- ESS and BESS circuit protection
- Inverter Protection
- Power storage protection

AGENCY INFORMATION

- Designed to UL 248-20
- Manufactured under IATF 16949 quality system
- RoHS and REACH Compliant

PART NUMBER SYSTEM

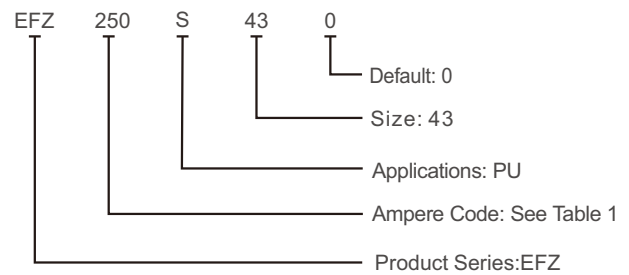

ELECTRICAL SPECIFICATIONS

Size (mm)	Part Number	Rated Current	Ampere Code	Rated Voltage	Breaking Capacity	I ² t (A ² sec)		1.0 In Dissipation (W)
						Self-test	Pre-arcing	
84x43	EFZ310S430	100A	100	1500 Vdc	30 kA	1680	10700	32
	EFZ316S430	160 A	160			4500	29000	45
	EFZ320S430	200 A	200			75300	51000	53
	EFZ325S430	250 A	250			12400	86800	62
	EFZ330S430	300 A	300			18810	137500	72

Table1 Note:(1).Temperature rise: 0.5In < 50K.
(2).Recommend mounting torque is 12+/-1.0Nm (M8)

DIMENSIONS (mm)

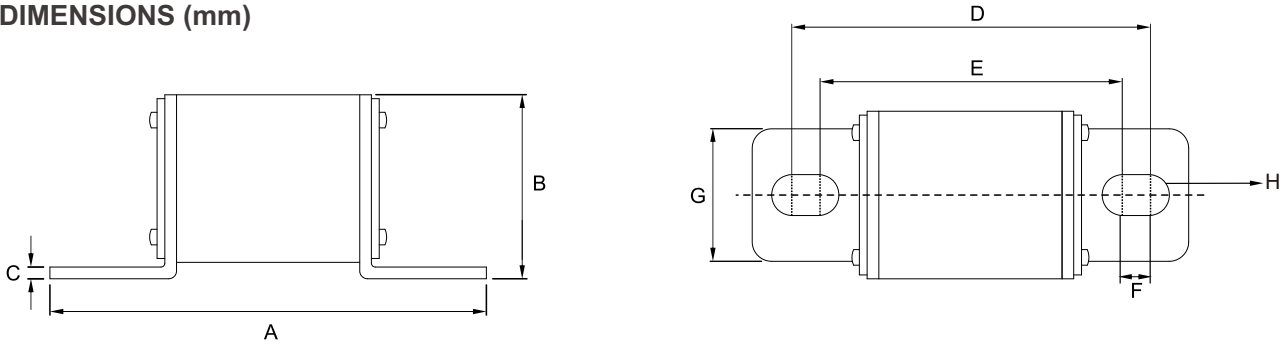

Fuse Size	A±1.5	B±1.5	C±0.2	D±1.5	E±1.5	F±0.5	G±0.5	H±0.3
84x43	136	47.2	3	116	103	6.5	26	φ10.3

Table2

TIME CURRENT CURVE

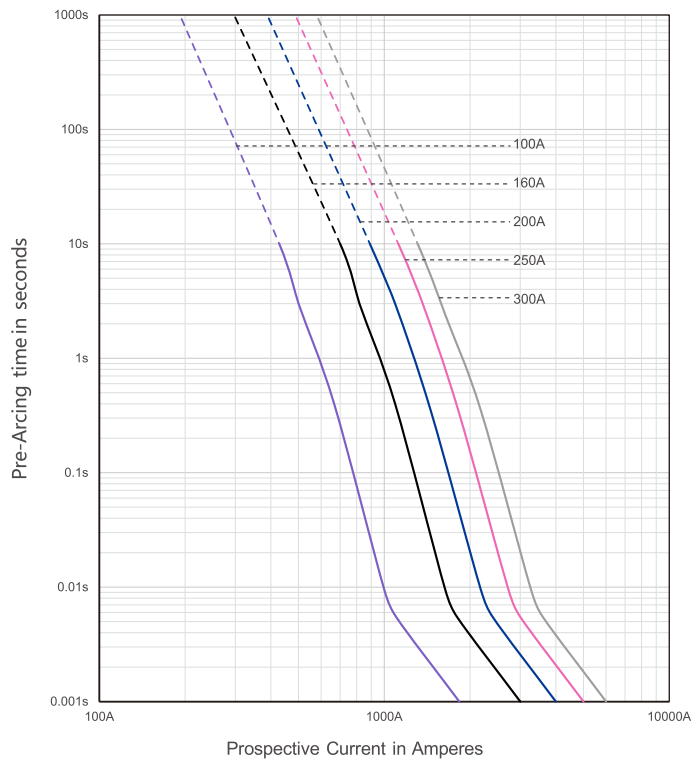

A95 1500 Vdc ESS Fuse 24x65mm



DESCRIPTION

Adler A95 series ESS fuses are engineered and manufactured for use in Industrial ESS and Power Distribution Protection, made from the highest quality materials and tested to the highest standards. With rated currents from 35A to 100A with a breaking capacity of 30kA.

FEATURES

- 1500 Vdc, 24x65 mm PU fuse link with glass-fiber body
- Rated Current: 35-100A
- Breaking Capacity: 30 kA @ 1500 Vdc
- Time Constant: 1-3 ms
- Special design with silver plated caps for high-power PU applications
- BH500, BH501 holders for DIN rail mounting
- Customizable for special applications

APPLICATIONS

- ESS and BESS circuit protection
- Inverter Protection
- Power storage protection

AGENCY INFORMATION

- Comply to: UL 248, IEC 60269
- Manufactured under IATF 16949 quality system
- RoHS and REACH Compliant

PART NUMBERING SYSTEM

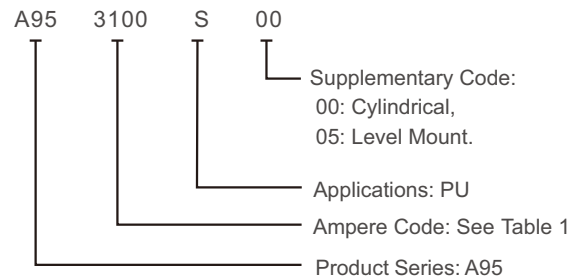

ELECTRICAL SPECIFICATIONS

Part Number		Rated Current	Ampere Code	Breaking Capacity	I ² t (A ² s)		Dissipation (W)		Certifications	
Cartridge	Level Mount				Pre-Arcing	Total	0.8 I _n	1.0 I _n	UL	TUV
A952350S00	A952350S05	35 A	2350	30 kA@ 1500 Vdc	1600	5100	6	7.5	•	•
A952400S00	A952400S05	40 A	2400		3000	6500	6.6	8.2	•	•
A952450S00	A952450S05	45A	2450		4500	8500	6.8	8.5	•	•
A952500S00	A952500S05	50 A	2500		7000	14500	7.2	9	•	•
A952550S00	A952550S05	55 A	2550		8500	15500	8	10	•	•
A952600S00	A952600S05	60 A	2600		10500	19000	8.8	11	•	•
A952630S00	A952630S05	63 A	2630		11000	20000	9.0	11.2	•	•
A952650S00	A952650S05	65 A	2650		12000	22000	9.6	12	•	•
A952700S00	A952700S05	70 A	2700		16500	29000	10.4	13	•	•
A952800S00	A952800S05	80 A	2800		20000	33000	12.8	16	•	•
A952900S00	A952900S05	90 A	2900		25000	39000	13.6	17	•	•
A953100S00	A953100S05	100 A	3100		32000	90000	14.4	18	•	•

Table 1 Note: (1) Operating temperature range: -40°C -90°C.
(2)•=Certification obtained.

DIMENSIONS (mm)

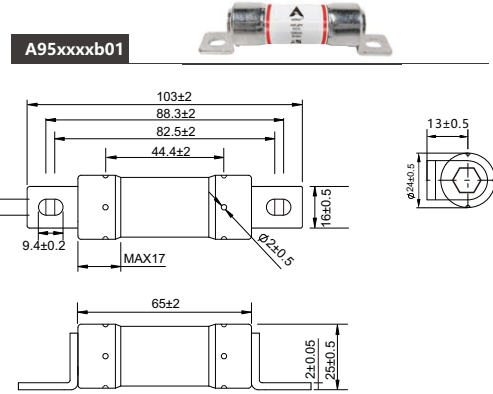
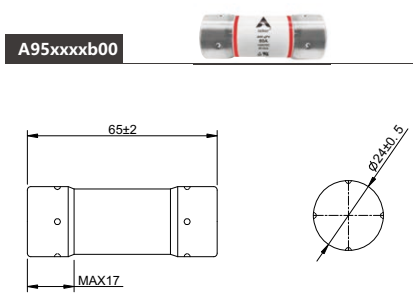

TIME CURRENT CURVE

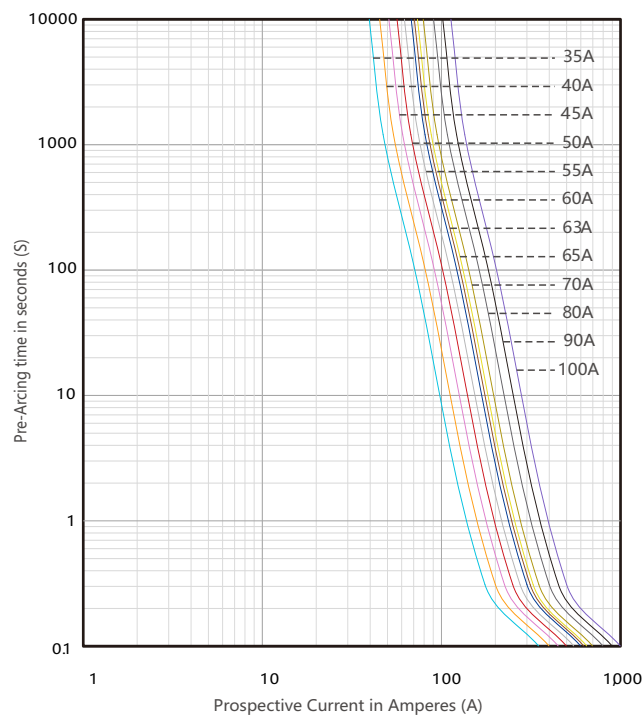

AX8 1500 Vdc ESS Fuse

RoHS 

DESCRIPTION

Adler AX8 series ESS fuses are engineered and manufactured for use in Industrial ESS and Power Distribution Protection, made from the highest quality materials and tested to the highest standards. With rated currents from 450A to 630A with a breaking capacity of 50kA.

FEATURES

- Reliable clearing of DC fault currents
- High cycling performance
- Low watt losses
- Ultra-compact size and power density
- High breaking capacity to 50kA
- Operation as low as 200% In overload protection
- Full coverage of battery module current
- QR code marks on each fuse for traceability

AGENCY INFORMATION

- Designed to IEC60269-6, UL248-19
- Manufactured under IATF 16949 quality system
- RoHS and REACH Compliant

APPLICATIONS

- ESS and BESS circuit protection
- Inverter Protection
- Power storage protection

PART NUMBERING SYSTEM

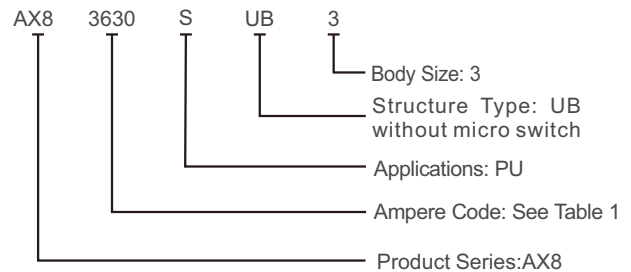

ELECTRICAL SPECIFICATIONS

Size (mm)	Part number			Rated Current	Ampere Code	Rated Voltage	Breaking Capacity	Pre-arcing I ² t	Clearing I ² t	Watt Loss (W)	Certifications
	Din	Bolted	Flush				Self-Certified	(A ² S)	(A ² S)	1.0In	TUV
3	AX83450SDB3	AX83450SUB3	AX83450SFB3	450A	3450	1500 Vdc	50kA	160000	481600	80	○
	AX83500SDB3	AX83500SUB3	AX83500SFB3	500A	3500	1500 Vdc	50kA	205000	617100	86	○
	AX83550SDB3	AX83550SUB3	AX83550SFB3	550A	3550	1500 Vdc	50kA	268000	806600	94	○
	AX83630SDB3	AX83630SUB3	AX83630SFB3	630A	3630	1500 Vdc	50kA	375000	1132500	100	○

Table1 Note:(1)Time constant: 1~3ms
(2)○ = TUV certification in process

DIMENSIONS (mm)

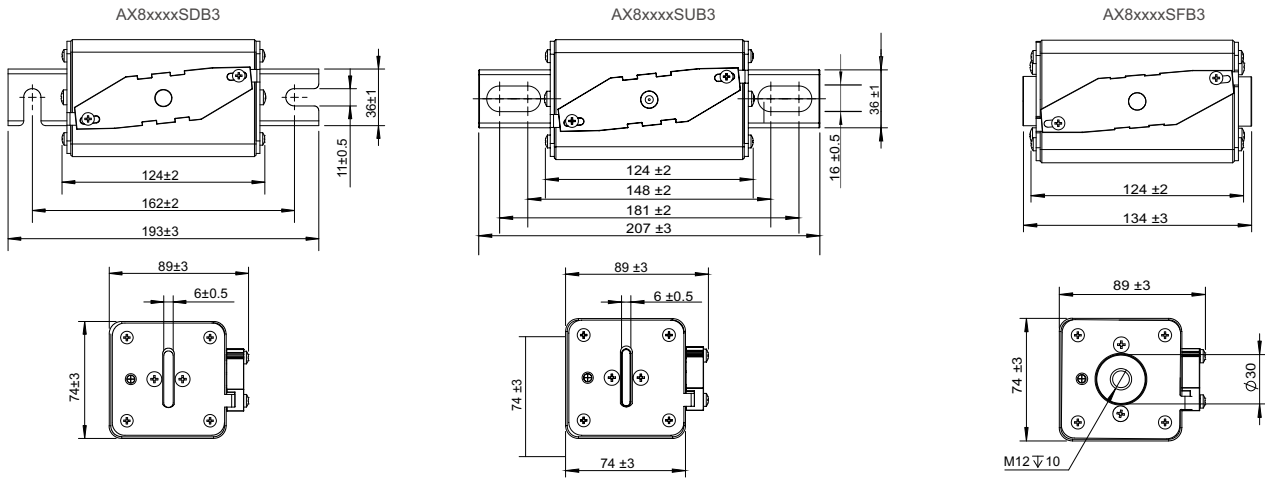

TIME CURRENT CURVE

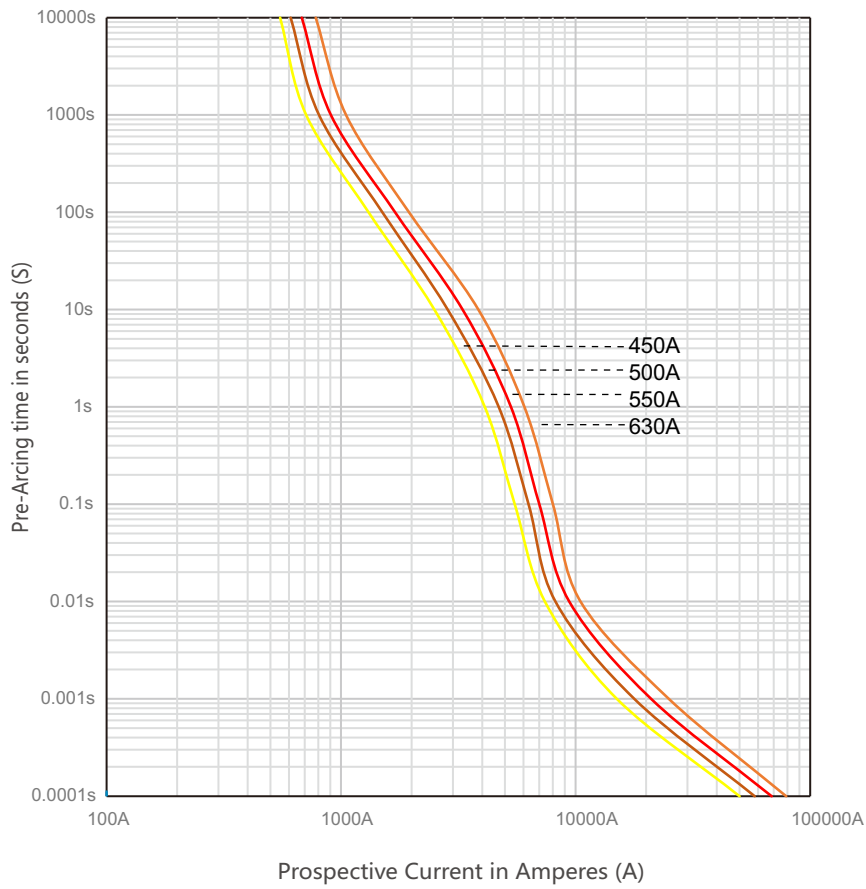

AHE 2# 1500 Vdc ESS Fuse



DESCRIPTION

Adler AHE2# ESS series power fuses are specially engineered and tested to provide excellent protection performance in Industrial ESS and Power Distribution Protection. With currents from 200A to 800A with a breaking capacity of 250kA.

FEATURES

- Rated Voltage: 1500 Vdc
- Amperage Rating: 160A-800A
- Breaking Capacity: 250kA
- Time Constant: 3 ~ 5ms
- Class Type: aR
- Strong current limiting capacity
- AHE series PN in this datasheet is without microswitch
- Optional microswitch available PN: MS0003

APPLICATIONS

- Industrial ESS and BESS protection
- Power Distribution Protection

AGENCY INFORMATION

- Ref. to IEC 60269-1 / IEC 60269-4
- Approval: UL & TUV
- Manufactured under IATF 16949 quality system
- RoHS and REACH Compliant

PART NUMBERING SYSTEM

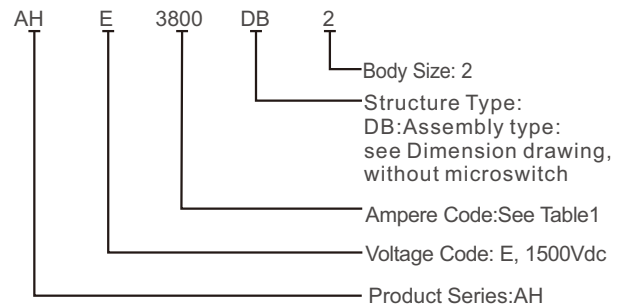

ELECTRICAL SPECIFICATIONS

Size	Part number						Ampere Code	Rated Current	Rated Voltage	Breaking Capacity	I ² t (A ² s)		Power Loss / W_100% Rated
	Din	Bolted	Flush	Customize		Pre-Arcing					Total		
ESS 2#	AHE3160DB2	AHE3160UB2	AHE3160FL2	AHE160CUB2	AHE0160UB2	AHE160CDB2	3160	160A	1500Vdc	250kA	4850	12150	81.0
	AHE3200DB2	AHE3200UB2	AHE3200FL2	AHE200CUB2	AHE0200UB2	AHE200CDB2	3200	200A	1500Vdc	250kA	12900	32508	90.0
	AHE3250DB2	AHE3250UB2	AHE3250FL2	AHE250CUB2	AHE0250UB2	AHE250CDB2	3250	250A	1500Vdc	250kA	20667	52702	113.0
	AHE3280DB2	AHE3280UB2	AHE3280FL2	AHE280CUB2	AHE0280UB2	AHE280CDB2	3280	280A	1500Vdc	250kA	24704	63737	125.6
	AHE3315DB2	AHE3315UB2	AHE3315FL2	AHE315CUB2	AHE0315UB2	AHE315CDB2	3315	315A	1500Vdc	250kA	34406	89799	133.8
	AHE3350DB2	AHE3350UB2	AHE3350FL2	AHE350CUB2	AHE0350UB2	AHE350CDB2	3350	350A	1500Vdc	250kA	45240	119433	143.0
	AHE3400DB2	AHE3400UB2	AHE3400FL2	AHE400CUB2	AHE0400UB2	AHE400CDB2	3400	400A	1500Vdc	250kA	64361	171844	159.3
	AHE3450DB2	AHE3450UB2	AHE3450FL2	AHE450CUB2	AHE0450UB2	AHE450CDB2	3450	450A	1500Vdc	250kA	85836	231757	168.9
	AHE3500DB2	AHE3500UB2	AHE3500FL2	AHE500CUB2	AHE0500UB2	AHE500CDB2	3500	500A	1500Vdc	250kA	109226	298187	183.2
	AHE3550DB2	AHE3550UB2	AHE3550FL2	AHE550CUB2	AHE0550UB2	AHE550CDB2	3550	550A	1500Vdc	250kA	134094	370099	204.4
	AHE3630DB2	AHE3630UB2	AHE3630FL2	AHE630CUB2	AHE0630UB2	AHE630CDB2	3630	630A	1500Vdc	250kA	194817	543539	213.2
	AHE3700DB2	AHE3700UB2	AHE3700FL2	AHE700CUB2	AHE0700UB2	AHE700CDB2	3700	700A	1500Vdc	250kA	263007	741680	236.5
	AHE3800DB2	AHE3800UB2	AHE3800FL2	AHE800CUB2	AHE0800UB2	AHE800CDB2	3800	800A	1500Vdc	250kA	389471	110993	253.4

Table 1

DIMENSIONS (mm)

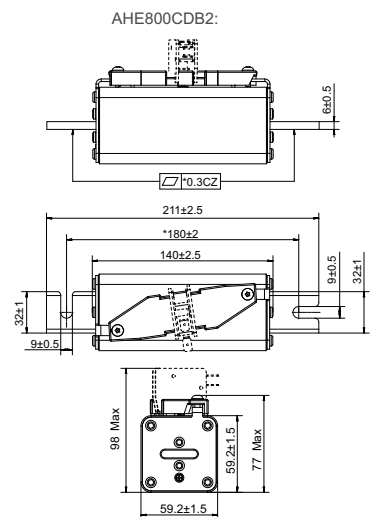
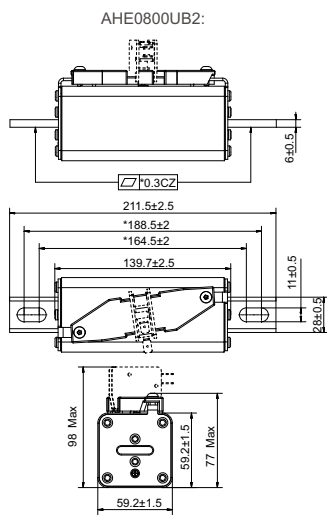
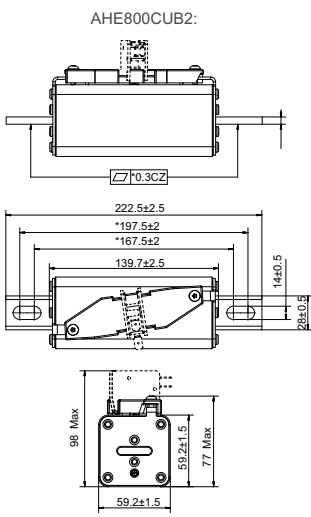
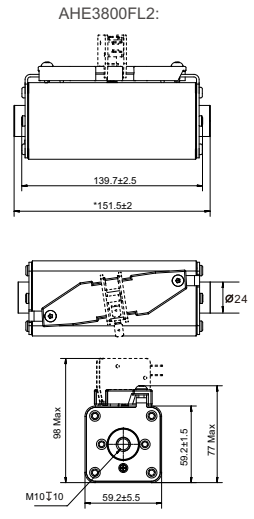
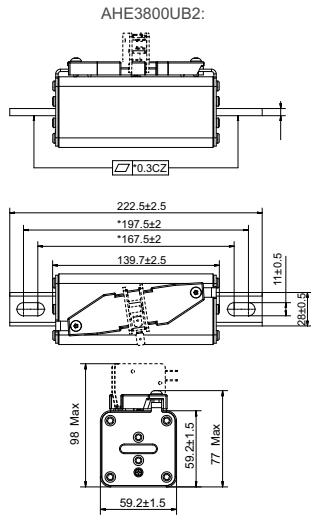
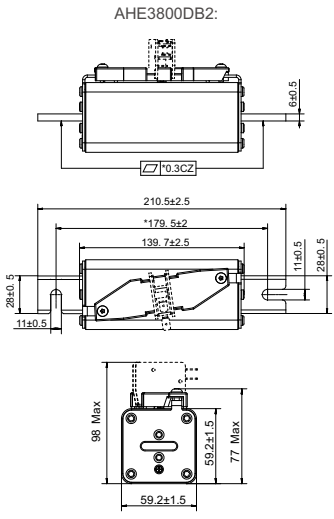

TIME CURRENT CURVE

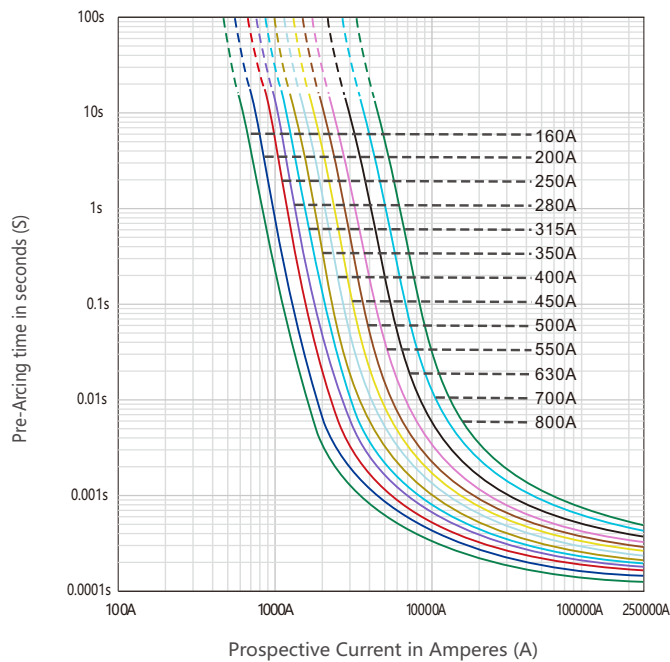

AHE 3# 1500Vdc ESS Fuse



DESCRIPTION

Adler AHE3# ESS series power fuses are specially engineered and tested to provide excellent protection performance in Industrial ESS and Power Distribution Protection. With currents from 315A to 1200A with a breaking capacity of 250kA.

FEATURES

- Rated Voltage: 1500 Vdc
- Amperage Rating: 315A-1200A
- Breaking Capacity: 250kA
- Time Constant: 3~5ms
- Class Type: aR
- Strong current limiting capacity
- AHE series PN in this datasheet is without microswitch
- Optional microswitch available PN: MS0003

APPLICATIONS

- Industrial ESS and BESS protection
- Power Distribution Protection

AGENCY INFORMATION

- Ref. to IEC 60269-1 / IEC 60269-4
- Approval: UL & TUV
- Manufactured under IATF 16949 quality system
- RoHS and REACH Compliant

PART NUMBERING SYSTEM

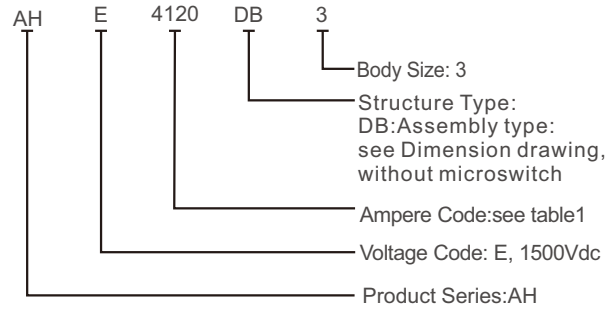

ELECTRICAL SPECIFICATIONS

Size	Part number				Ampere Code	Rated Current	Rated Voltage	Breaking Capacity	I ² t (A ² s)		Power Loss / W_100% Rated
	Din	Bolted	Flush	Customize					Pre-Arcing	Total	
ESS 2#	AHE3315DB3	AHE3315UB3	AHE3315FL3	AHE0315CDB3	3315	315A	1500Vdc	250kA	21132	76076	129.6
	AHE3350DB3	AHE3350UB3	AHE3350FL3	AHE0350CDB3	3350	350A	1500Vdc	250kA	29035	103654	141.0
	AHE3400DB3	AHE3400UB3	AHE3400FL3	AHE0400CDB3	3400	400A	1500Vdc	250kA	38277	134736	162.7
	AHE3450DB3	AHE3450UB3	AHE3450FL3	AHE0450CDB3	3450	450A	1500Vdc	250kA	54477	189034	178.3
	AHE3500DB3	AHE3500UB3	AHE3500FL3	AHE0500CDB3	3500	500A	1500Vdc	250kA	73708	254293	194.1
	AHE3550DB3	AHE3550UB3	AHE3550FL3	AHE0550CDB3	3550	550A	1500Vdc	250kA	92243	310858	210.7
	AHE3630DB3	AHE3630UB3	AHE3630FL3	AHE0630CDB3	3630	630A	1500Vdc	250kA	13040	429029	235.9
	AHE3700DB3	AHE3700UB3	AHE3700FL3	AHE0700CDB3	3700	700A	1500Vdc	250kA	180848	582330	256.8
	AHE3800DB3	AHE3800UB3	AHE3800FL3	AHE0800CDB3	3800	800A	1500Vdc	250kA	280489	876249	268.0
	AHE3900DB3	AHE3900UB3	AHE3900FL3	AHE0900CDB3	3900	900A	1500Vdc	250kA	404951	1222952	287.8
	AHE4100DB3	AHE4100UB3	AHE4100FL3	AHE1000CDB3	4100	1000A	1500Vdc	250kA	544267	1589259	338.2
	AHE4110DB3	AHE4110UB3	AHE4110FL3	AHE1100CDB3	4110	1100A	1500Vdc	250kA	747801	2108800	347.6
	AHE4120DB3	AHE4120UB3	AHE4120FL3	AHE1200CDB3	4120	1200A	1500Vdc	250kA	1011651	2751692	359.4

Table1

DIMENSIONS (mm)

AHE4120DB3:

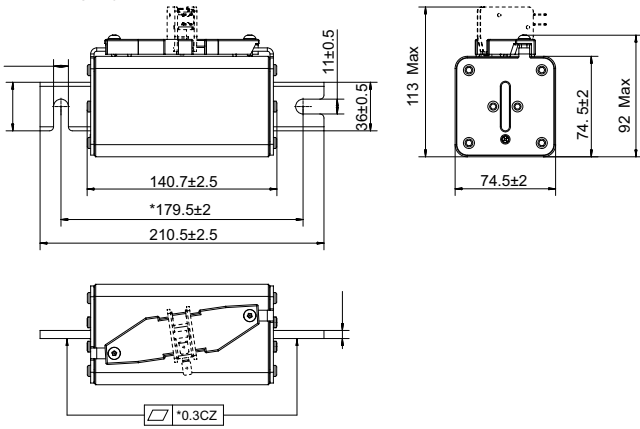

AHE4120UB3:

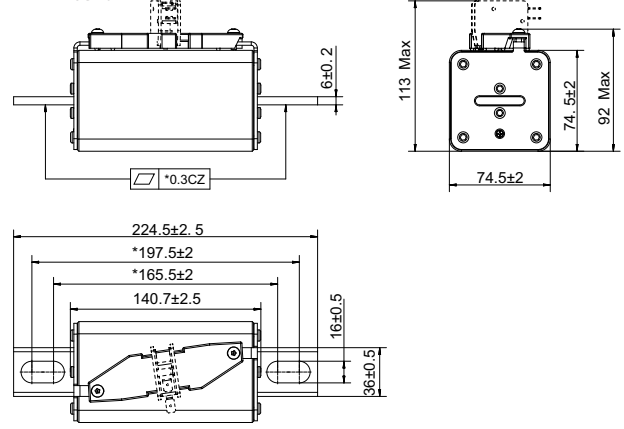

AHE4120FL3:

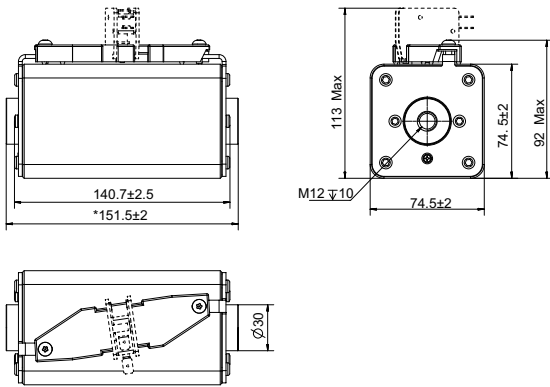

AHE1200CDB3:

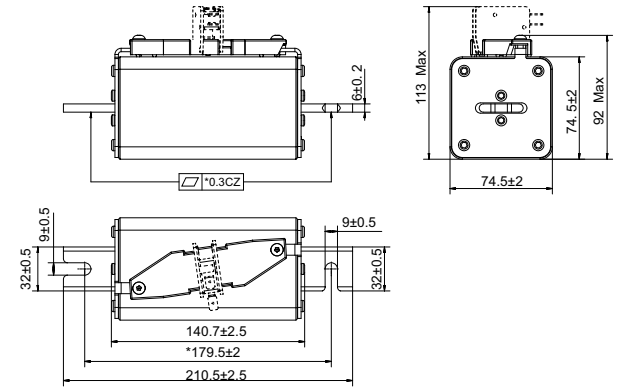

TIME CURRENT CURVE

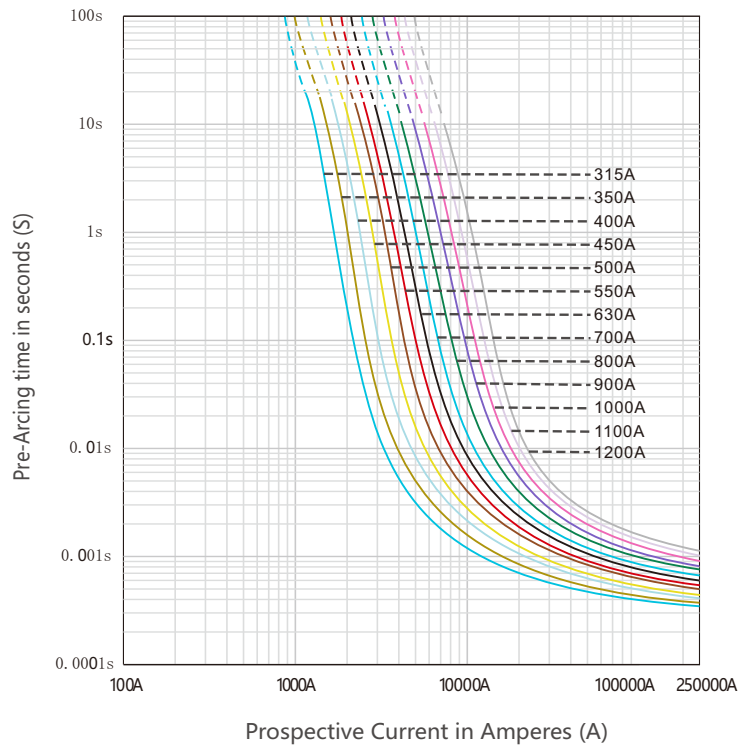

AHE 4# 1500Vdc ESS Fuse



Coming Soon

FEATURES:

- Rated Voltage: 1500 Vdc
- Amperage Rating: 1000A-1800A
- Breaking Capacity: 250kA
- Class Type: aR

DIMENSIONS (mm)

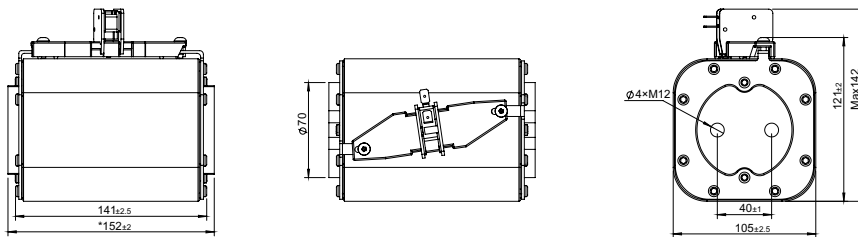

AHE 5# 1500Vdc ESS Fuse



Coming Soon

FEATURES:

- Rated Voltage: 1500 Vdc
- Amperage Rating: 2000A-3000A
- Breaking Capacity: 250kA
- Class Type: aR

DIMENSIONS (mm)

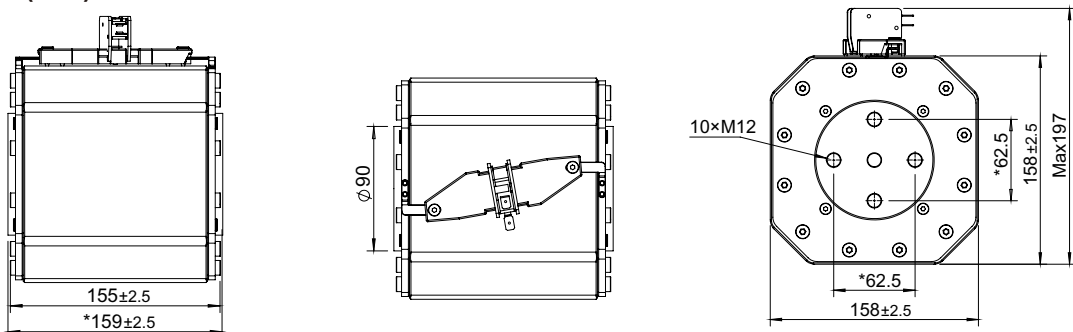

AXE 1500Vdc ESS Fuse



DESCRIPTION

Adler AXE series ESS fuses are engineered and manufactured for use in Industrial ESS and Power Distribution Protection, made from the highest quality materials and tested to the highest standards. With rated currents from 125A to 400A with a breaking capacity of 50kA.

FEATURES

- Reliable clearing of DC fault currents
- High cycling performance
- Low watt losses
- High Breaking Capacity to 50kA
- Time Constant: 1~3ms
- Class Type: gR
- AXE series PN in this datasheet is without microswitch
Optional microswitch PN: MS0003

AGENCY INFORMATION

- Ref. standard: IEC 60269 / GB 13539
- UL Certification
- Manufactured under IATF 16949 quality system
- RoHS and REACH Compliant

APPLICATIONS

- ESS and BESS circuit protection
- Inverter Protection
- Power storage protection

PART NUMBERING SYSTEM

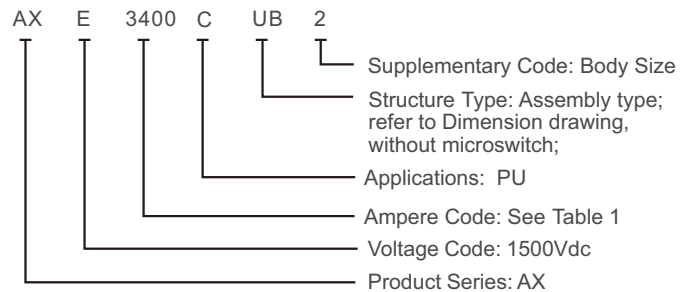

ELECTRICAL SPECIFICATIONS

Case Size	Part Number	Rated Current	Ampere Code	Rated Voltage	Breaking Capacity	I ² t(A ² S)	
	Bolted				Self-Certified	Pre-arcing	Total
AXE 2#	AXE3125CUB2	125A	3125	1500 Vdc	50kA	5400	38900
	AXE3160CUB2	160A	3160	1500 Vdc	50kA	7600	54500
	AXE3200CUB2	200A	3200	1500 Vdc	50kA	9900	70900
	AXE3250CUB2	250A	3250	1500 Vdc	50kA	17600	126000
	AXE3315CUB2	315A	3315	1500 Vdc	50kA	31300	224100
	AXE3350CUB2	350A	3350	1500 Vdc	50kA	44200	316000
	AXE3400CUB2	400A	3400	1500 Vdc	50kA	64500	500000

Table1

DIMENSIONS (mm)

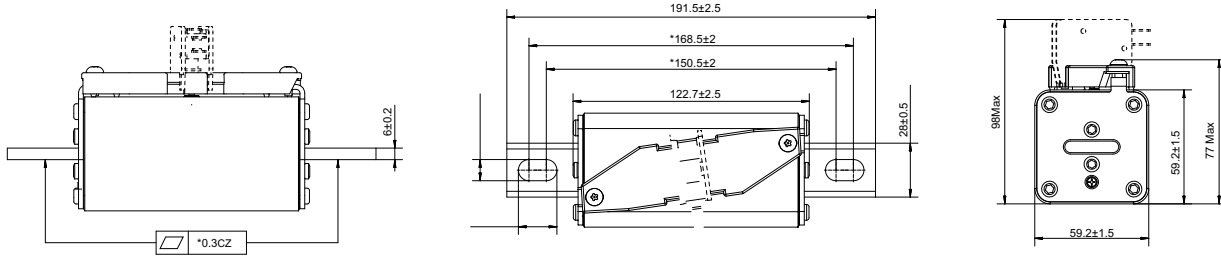

TIME CURRENT CURVE

